

Pressure

CHARLOTTE
PIPE AND FOUNDRY COMPANY®

DIMENSIONAL CATALOG

PVC and **CORZAN**® CPVC
Schedule 80 Pipe and Fittings

PVC Schedule 40 Pipe and
Fittings

FlowGuard Gold® CPVC CTS
Pipe and Fittings

[Updated April 2009]

You can't beat the system.®

© 2001-2009 Charlotte Pipe and Foundry Company

DC-PR

PRESSURE PIPE AND FITTINGS DIMENSIONAL CATALOG

TABLE OF CONTENTS

	Page
Pipe Data - PVC Schedule 80, Plain End.....	3
Pipe Data - PVC Schedule 80, Belled End.....	4
Pipe Data - CPVC Schedule 80, Plain End	5
Schedule 80 and Schedule 40 Tapered Socket Dimensions	6
American National Standard Taper Pipe Threads.....	6
PVC and Corzan® CPVC Schedule 80 Fittings Dimensions and Weights.....	7-22
Pipe Data - PVC Schedule 40, Plain End.....	23
Pipe Data - PVC Schedule 40, Belled End.....	24
Pipe Data - PVC Well Casing and SDR Pipe.....	25
PVC Schedule 40 Fittings Dimensions and Weights	26-44
Pipe Data - FlowGuard® CPVC CTS SDR 11	45
FlowGuard Gold® CPVC CTS Fitting Dimensions	46
Limited Warranty.....	47
FlowGuard Gold® Limited Warranty.....	48

You can't beat the system.®

Charlotte Pipe and "You can't beat the system" are registered trademarks
of Charlotte Pipe and Foundry Company.

Corzan and FlowGuard Gold are registered trademarks of The Lubrizol Corporation.

PVC Schedule 80 Pipe



PVC Schedule 80 Pipe, Type 1, Grade 1 - Plain End

PVC SCHEDULE 80 (GRAY)			PLAIN END				PVC 1120	
PART NO.	NOM. SIZE	UPC # 611942-	TRUCKLOAD PERCENT PER SKID	QTY. PER SKID	AVG. OD (IN.)	MIN. WALL (IN.)	MAX WORK PRESSURE AT 23° C OR 73° F	WT. PER 100 FT. (LBS.)
PVC 10002	1/4"x20'	04920	2.083	15140'	0.540	.119	1130 PSI	10.0
PVC 10003	3/8"x20'	04917	2.083	9360'	0.675	.126	920 PSI	13.8
PVC 10005	1/2"x20'	03968	2.083	6880'	0.840	.147	850 PSI	20.3
PVC 10007	3/4"x20'	03969	2.083	4200'	1.050	.154	690 PSI	27.5
PVC 10010	1"x20'	03970	2.191	3540'	1.315	.179	630 PSI	40.5
PVC 10012	1 1/4"x20'	03973	4.166	4240'	1.660	.191	520 PSI	55.9
PVC 10015	1 1/2"x20'	03976	4.165	3440'	1.900	.200	470 PSI	67.7
PVC 10020	2"x20'	03977	3.570	1980'	2.375	.218	400 PSI	93.6
PVC 10025	2 1/2"x20'	03978	3.570	1360'	2.875	.276	420 PSI	142.8
PVC 10030	3"x20'	03979	3.570	960'	3.500	.300	370 PSI	191.1
PVC 10040	4"x20'	03980	7.144	1080'	4.500	.337	320 PSI	279.3
PVC 10060	6"x20'	03981	7.144	480'	6.625	.432	280 PSI	532.7
PVC 10080	8"x20'	04175	8.330	300'	8.625	.500	250 PSI	808.9
PVC 10100	10"x20'	04768	7.144	160'	10.750	.593	230 PSI	1199.3
PVC 10120	12"x20'	04770	8.928	120'	12.750	.687	230 PSI	1650.1
PVC 10140	14"x20'	04816	4.160	60'	14.000	.750	220 PSI	1930.0
PVC 10160	16"x20'	04919	5.000	60'	16.000	.843	220 PSI	2544.1

Note: For truckloads of mixed sizes, multiply skids desired by truckload percent per skid.
 Full pallets are polyethylene wrapped for cleanliness and UV protection.

NSF Listed. Meets All Requirements of ASTM D 1784 and ASTM D 1785.

PVC piping products are not recommended for use with compressed air or gases.



PVC Schedule 80 Pipe



PVC Schedule 80 Pipe, Type 1, Grade 1 - Belled End

PVC SCHEDULE 80 (GRAY)			BELLED-END				PVC 1120	
PART NO.	NOM. SIZE	UPC # 611942-	TRUCKLOAD PERCENT PER SKID	QTY. PER SKID	AVG. OD (IN.)	MIN. WALL (IN.)	MAX WORK PRESSURE AT 23° C OR 73° F	WT. PER 100 FT. (LBS.)
PVC 10005B	½"x20'	04924	2.083	6880'	0.840	.147	850 PSI	20.3
PVC 10007B	¾"x20'	04925	2.083	4200'	1.050	.154	690 PSI	27.5
PVC 10010B	1"x20'	04926	2.083	3540'	1.315	.179	630 PSI	40.5
PVC 10012B	1¼"x20'	04927	4.166	4240'	1.660	.191	520 PSI	55.9
PVC 10015B	1½"x20'	04928	4.165	3440'	1.900	.200	470 PSI	67.7
PVC 10020B	2"x20'	04764	3.570	1980'	2.375	.218	400 PSI	93.6
PVC 10025B	2½"x20'	04875	3.570	1360'	2.875	.276	420 PSI	142.8
PVC 10030B	3"x20'	04776	3.570	960'	3.500	.300	370 PSI	191.1
PVC 10040B	4"x20'	04774	7.144	1080'	4.500	.337	320 PSI	279.3
PVC 10060B	6"x20'	04763	7.144	480'	6.625	.432	280 PSI	532.7
PVC 10080B	8"x20'	04766	7.144	300'	8.625	.500	250 PSI	808.9
PVC 10100B	10"x20'	04769	8.928	160'	10.750	.593	230 PSI	1199.3
PVC 10120B	12"x20'	04771	7.144	120'	12.750	.687	230 PSI	1650.1
PVC 10140B	14"x20'	04832	4.160	60'	14.000	.750	220 PSI	1930.0
PVC 10160B	16"x20'	09372	5.000	60'	16.000	.843	220 PSI	2544.1

Note: For truckloads of mixed sizes, multiply skids desired by truckload percent per skid.
Full pallets are polyethylene wrapped for cleanliness and UV protection.

NSF Listed. Meets All Requirements of ASTM D 1784 and ASTM D 1785.

PVC piping products are not recommended for use with compressed air or gases.



CPVC Schedule 80 Pipe

CORZAN® CPVC Schedule 80 Pipe, Type IV, Grade 1

PVC SCHEDULE 80 (LIGHT GRAY)				PLAIN END			CPVC 4120	
PART NO.	NOM. SIZE	UPC # 611942-	TRUCKLOAD PERCENT PER SKID	QTY. PER SKID	AVG. OD (IN.)	MIN. WALL (IN.)	MAX WORK PRESSURE AT 23° C OR 73° F	WT. PER 100 FT. (LBS.)
CPV 11002	¼"x20'	04931	3.570	15140'	.540	.119	1130 PSI	10.9
CPV 11003	⅜"x20'	04943	3.570	9360'	.675	.126	920 PSI	15.0
CPV 11005	½"x20'	04787	3.570	6880'	.840	.147	850 PSI	22.1
CPV 11007	¾"x20'	04788	3.570	4200'	1.050	.154	690 PSI	30.0
CPV 11010	1"x20'	04789	3.570	3540'	1.315	.179	630 PSI	44.2
CPV 11012	1¼"x20'	04790	3.570	4240'	1.660	.191	520 PSI	61.0
CPV 11015	1½"x20'	04791	4.165	3440'	1.900	.200	470 PSI	73.9
CPV 11020	2"x20'	04792	3.570	1980'	2.375	.218	400 PSI	102.2
CPV 11025	2½"x20'	04793	3.570	1360'	2.875	.276	420 PSI	155.9
CPV 11030	3"x20'	04794	3.570	960'	3.500	.300	370 PSI	208.6
CPV 11040	4"x20'	04795	7.144	1080'	4.500	.337	320 PSI	304.9
CPV 11060	6"x20'	04796	7.144	480'	6.625	.432	280 PSI	581.5
CPV 11080	8"x20'	04797	8.330	300'	8.625	.500	250 PSI	882.9

Note: For truckloads of mixed sizes, multiply skids desired by truckload percent per skid.
 Full pallets are polyethylene wrapped for cleanliness and UV protection.

NSF Listed. Meets All Requirements of ASTM D 1784 and ASTM F 441.

CPVC piping products are not recommended for use with compressed air or gases.



Schedule 80 Fittings

SCHEDULE 80 AND SCHEDULE 40 TAPERED SOCKET DIMENSIONS

PVC SCHEDULE 80 - ASTM D 2467
CPVC SCHEDULE 80 - ASTM F 439
PVC SCHEDULE 40 - ASTM D 2466

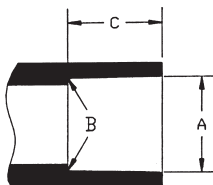

Nominal Size	Schedule 80 and Schedule 40 Socket Diameter			Schedule 80 Socket Length C (Minimum)	Schedule 40 Socket Length C (Minimum)
	Entrance A	Bottom B	Tolerance		
1/2	0.848	0.836	±0.004	0.875	0.688
3/4	1.058	1.046	±0.004	1.000	0.719
1	1.325	1.310	±0.005	1.125	0.875
1 1/4	1.670	1.655	±0.005	1.250	0.938
1 1/2	1.912	1.894	±0.006	1.375	1.094
2	2.387	2.369	±0.006	1.500	1.156
2 1/2	2.889	2.868	±0.007	1.750	1.750
3	3.516	3.492	±0.008	1.875	1.875
4	4.518	4.491	±0.009	2.250	2.000
6	6.647	6.614	±0.011	3.000	3.000
8	8.655	8.610	±0.015	4.000	4.000

AMERICAN NATIONAL STANDARD TAPER PIPE THREADS (NPT)

ANSI / ASME B1.20.1,
ASTM D 2464, ASTM F 437,
ASTM F 1498

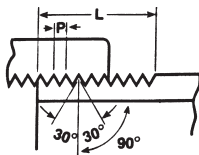

Nominal Size	Effective Thread Length (L)	Threads Per Inch	Pitch of Thread (P)
1/2	0.5337	14.0	.07143
3/4	0.5457	14.0	.07143
1	0.6828	11.5	.08696
1 1/4	0.7068	11.5	.08696
1 1/2	0.7235	11.5	.08696
2	0.7565	11.5	.08696
2 1/2	1.1375	8.0	.12500
3	1.2000	8.0	.12500
4	1.3000	8.0	.12500

- S = SOCKET, SPG = SPIGOT, MPT = MALE PIPE THREAD, FPT = FEMALE PIPE THREAD
- ALL DIMENSIONS ARE IN INCHES.

TOLERANCES

- S = (SOCKET LENGTH) MINIMUM
 - G = (LAYING LENGTH) INTERSECTION OF CENTER LINES TO BOTTOM OF SOCKET/THREAD, 90° ELBOWS, TEES, CROSSES, $\pm 1/32''$
 - H = INTERSECTION OF CENTER LINES TO FACE OF FITTINGS; 90° ELBOWS, TEES, CROSSES, $\pm 1/32''$
 - J = (LAYING LENGTH) INTERSECTION OF CENTER LINES TO BOTTOM OF SOCKET/THREAD; 45° ELBOWS, $\pm 1/32''$
 - L = OVERALL LENGTH OF FITTINGS, (INCLUDING CAPS), $\pm 1/16''$
 - M = OUTSIDE DIAMETER OF SOCKET/THREAD HUB, $\pm 1/16''$
 - N = SOCKET/THREAD BOTTOM TO SOCKET/THREAD BOTTOM; COUPLINGS, $\pm 1/16''$
- DIMENSIONS ARE SUBJECT TO CHANGE WITHOUT NOTIFICATION.

TEE (SXSXS)

PVC PART NO. 8400
CPVC PART NO. 8400C

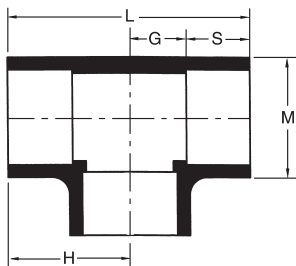

Size	Universal Part Number		L	M	H	G	S	Approx. Wt. (Lbs.)	
	PVC	CPVC						PVC	CPVC
1/2	801-005	801-005C	2 15/16	1 3/16	1 19/32	19/32	7/8	0.11	0.12
3/4	801-007	801-007C	3 7/16	1 7/16	1 23/32	11/16	1	0.17	0.18
1	801-010	801-010C	4	1 3/4	2	27/32	1 1/8	0.28	0.30
1 1/4	801-012	801-012C	4 9/16	2 1/16	2 9/32	1	1 1/4	0.39	0.46
1 1/2	801-015	801-015C	4 7/8	2 3/8	2 7/16	1 1/32	1 3/8	0.51	0.55
2	801-020	801-020C	5 3/4	2 7/8	2 7/8	1 5/16	1 1/2	0.82	0.89
2 1/2	801-025	801-025C	6 15/16	3 1/2	3 15/32	1 21/32	1 3/4	1.49	1.60
3	801-030	801-030C	7 1/2	4 1/8	3 3/4	1 27/32	1 7/8	2.24	1.70
4	801-040	801-040C	9 3/8	5 1/4	4 11/16	2 7/16	2 1/4	3.76	4.00
6	801-060	801-060C	14 1/8	7 17/32	7 1/16	4 1/32	3	10.75	11.61
8	801-080	801-080C	17 19/32	9 11/16	8 13/16	4 3/4	4	20.13	21.53

REDUCING TEE

(S x S x S)

PVC PART NO. 8400

CPVC PART NO. 8400C

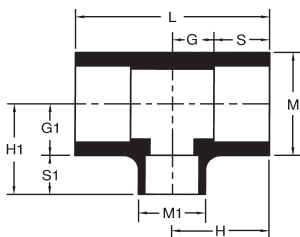

Size	Universal Part Number		L	M	H	H1
	PVC	CPVC				
3/4 x 3/4 x 1/2	801-101	801-101C	3 3/16	1 13/32	1 19/32	1 21/32
1 x 1 x 1/2	801-130	801-130C	4 15/32	1 11/16	1 3/4	1 19/32
1 x 1 x 3/4	801-131	801-131C	3 21/32	1 23/32	1 13/16	1 21/32
1 1/4 x 1 1/4 x 1	801-168	801-168C	2 1/4	2 3/32	2 1/8	2 1/16
1 1/2 x 1 1/2 x 3/4	801-210	801-210C	4 5/32	2 5/32	2 3/32	2 1/32
1 1/2 x 1 1/2 x 1	801-211	801-211C	4 1/2	2 11/32	2 1/4	2 9/32
1 1/2 x 1 1/2 x 1 1/4	801-212	801-212C	5 3/8	2 5/16	2 5/8	2 5/16
2 x 2 x 1/2	801-247	801-247C	4 5/32	2 27/32	2 3/32	2 5/32
2 x 2 x 3/4	801-248	801-248C	4 13/32	2 27/32	2 7/32	2 9/32
2 x 2 x 1	801-249	801-249C	4 3/4	2 7/8	2 3/8	2 9/16
2 x 2 x 1 1/2	801-251	801-251C	5 3/8	2 7/8	2 11/16	2 13/16
3 x 3 x 2	801-338	801-338C	6 5/8	4 5/32	3 5/16	3 11/32
4 x 4 x 2	801-420	801-420C	7 9/16	5 1/4	3 25/32	4 1/8
4 x 4 x 3	801-422	801-422C	8 5/8	5 3/16	4 5/16	4 5/32
6 x 6 x 2	801-528	801-528C	9 17/32	7 17/32	4 29/32	5 1/16
6 x 6 x 4	801-532	801-532C	11 1/2	7 17/32	5 3/4	6
8 x 8 x 6	801-585	801-585C	15 5/8	9 11/16	7 13/16	7 1/8

Size	M1	S1	G	S	G1	Approx. Wt. (Lbs.)	
						PVC	CPVC
3/4 x 3/4 x 1/2	1 3/16	29/32	9/16	1 1/32	3/4	0.15	0.16
1 x 1 x 1/2	1 5/32	29/32	19/32	1 5/32	11/16	0.23	0.24
1 x 1 x 3/4	1 13/32	1 1/32	11/16	1 1/8	27/32	0.23	0.24
1 1/4 x 1 1/4 x 1	1 23/32	1 5/32	7/8	1 9/32	15/16	0.36	0.37
1 1/2 x 1 1/2 x 3/4	1 3/8	1 1/32	11/16	1 13/32	1	0.36	0.37
1 1/2 x 1 1/2 x 1	1 11/16	1 1/8	7/8	1 13/32	1 5/32	0.42	0.46
1 1/2 x 1 1/2 x 1 1/4	2 1/16	1 9/32	1 3/16	1 13/32	1 1/32	0.51	0.54
2 x 2 x 1/2	1 5/32	29/32	9/16	1 17/32	1 1/4	0.44	0.47
2 x 2 x 3/4	1 3/8	1 1/32	11/16	1 17/32	1 1/4	0.48	0.51
2 x 2 x 1	1 23/32	1 5/32	7/8	1 1/2	1 13/32	0.60	0.65
2 x 2 x 1 1/2	2 11/32	1 13/32	1 3/16	1 1/2	1 13/32	0.73	0.76
3 x 3 x 2	2 7/8	1 17/32	1 7/16	1 7/8	1 13/16	1.62	1.77
4 x 4 x 2	2 7/8	1 17/32	1 1/2	2 9/32	2 5/8	2.77	2.92
4 x 4 x 3	4 5/32	1 29/32	2 1/16	2 1/4	2 19/32	3.13	3.26
6 x 6 x 2	2 7/8	1 17/32	1 3/4	3 1/32	3 17/32	6.16	6.52
6 x 6 x 4	5 1/4	2 9/32	2 23/32	3	3 23/32	7.21	7.77
8 x 8 x 6	7 1/16	3 1/16	3 3/4	4 1/16	4 1/16	15.29	16.17

TEE

(S X S X FPT)

PVC PART NO. 8401

CPVC PART NO. 8401C

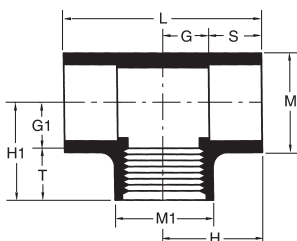

Size	Universal Part Number		L	M	H	G
	PVC	CPVC				
1/2	802-005	802-005C	2 13/16	1 5/16	1 13/32	17/32
3/4	802-007	802-007C	3 3/16	1 17/32	1 21/32	21/32
1	802-010	802-010C	3 11/16	1 27/32	1 27/32	23/32

Size	S	M1	H1	G1	T	Approx. Wt. (Lbs.)	
						PVC	CPVC
1/2	7/8	1 5/16	1 11/32	19/32	3/4	0.15	0.16
3/4	1	1 17/32	1 17/32	25/32	3/4	0.22	0.23
1	1 1/8	1 27/32	1 13/16	13/16	1	0.34	0.36

TEE

(FPT X FPT X FPT)

PVC PART NO. 8402

CPVC PART NO. 8402C

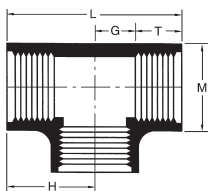

Size	Universal Part Number		L	M	H	G	T	Approx. Wt. (Lbs.)	
	PVC	CPVC						PVC	CPVC
1/2	805-005	805-005C	2 5/8	1 1/4	1 5/16	17/32	25/32	0.14	0.15
3/4	805-007	805-007C	2 15/16	1 1/2	1 15/32	1 21/32	13/16	0.19	0.21
1	805-010	805-010C	3 7/16	1 13/16	1 23/32	3/4	31/32	0.34	0.36
1 1/4	805-012	805-012C	3 7/8	2 1/4	1 15/16	15/16	1	0.48	0.52
1 1/2	805-015	805-015C	4 3/16	2 1/2	2 3/32	1 1/32	1 1/16	0.64	0.65
2	805-020	805-020C	4 3/4	3 1/16	2 3/8	1 5/16	1 1/16	0.90	0.97
2 1/2	805-025	805-025C	6 1/4	3 9/16	3 3/8	1 9/16	1 9/16	1.83	1.96
3	805-030	805-030C	7 1/16	4 5/16	3 17/32	1 29/32	1 5/8	2.73	2.91
4	805-040	805-040C	8 7/16	5 7/16	4 7/32	2 15/32	1 3/4	4.49	4.75

90 DEGREE ELBOW

(S X S)

PVC PART NO. 8300

CPVC PART NO. 8300C

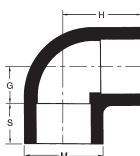

Size	Universal Part Number		M	H	G	S	Approx. Wt. (Lbs.)	
	PVC	CPVC					PVC	CPVC
1/2	806-005	806-005C	1 3/16	1 15/32	19/32	7/8	0.08	0.09
3/4	806-007	806-007C	1 13/32	1 11/16	11/16	1	0.12	0.13
1	806-010	806-010C	1 23/32	2	27/32	1 5/32	0.19	0.20
1 1/4	806-012	806-012C	2 1/16	2 7/32	1	1 7/32	0.31	0.33
1 1/2	806-015	806-015C	2 11/32	2 7/16	1 1/32	1 13/32	0.39	0.43
2	806-020	806-020C	2 7/8	2 27/32	1 5/16	1 1/2	0.62	0.67
2 1/2	806-025	806-025C	3 1/2	3 7/16	1 21/32	1 25/32	1.13	1.20
3	806-030	806-030C	4 5/32	3 3/4	1 27/32	1 29/32	1.60	1.72
4	806-040	806-040C	5 1/4	4 11/16	2 7/16	2 1/4	2.85	3.10
6	806-060	806-060C	7 19/32	6 11/16	3 11/16	3	8.27	8.79
8	806-080	806-080C	9 5/8	8 19/32	4 19/32	4	15.46	16.48

90 DEGREE ELBOW

(S X FPT)

PVC PART NO. 8301

CPVC PART NO. 8301C

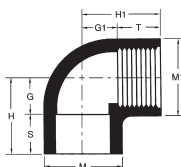

Size	Universal Part Number		M	H	G	S
	PVC	CPVC				
1/2	807-005	807-005C	1 5/16	1 3/8	1/2	7/8
3/4	807-007	807-007C	1 1/2	1 21/32	5/8	1 1/32
1	807-010	807-010C	1 27/32	1 27/32	23/32	1 1/8
1 1/4	807-012	807-012C	2 7/32	2 1/4	1 1/4	1
1 1/2	807-015	807-015C	2 17/32	2 3/8	1	1 3/8
2	807-020	807-020C	3 1/2	2 3/4	1 1/4	1 1/2

Size	M1	H1	G1	S1	Approx. Wt. (Lbs.)	
					PVC	CPVC
1/2	1 5/16	1 13/32	22/32	23/32	.138	.146
3/4	1 17/32	1 5/8	13/16	13/16	.188	.199
1	1 27/32	1 25/32	27/32	15/16	.259	.299
1 1/4	2 7/32	2	1	1	.434	.460
1 1/2	2 17/32	2 1/8	1 1/16	1 1/16	.562	.588
2	3 1/32	2 7/16	1 7/16	1	.802	.848

90 DEGREE ELBOW

(FPT X FPT)

PVC PART NO. 8302

CPVC PART NO. 8302C

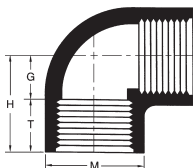

Size	Universal Part Number		M	T	G	H	Approx. Wt. (Lbs.)	
	PVC	CPVC					PVC	CPVC
1/2	808-005	808-005C	1 5/16	3/4	2 1/32	1 13/32	0.11	0.12
3/4	808-007	808-007C	1 1/2	25/32	2 1/32	1 5/8	0.18	0.17
1	808-010	808-010C	1 13/16	3 1/32	3/4	1 23/32	0.26	0.23
1 1/4	808-012	808-012C	2 1/4	1	3 1/32	1 3 1/32	0.42	0.37
1 1/2	808-015	808-015C	2 1/2	1 1/16	1 5/32	2 7/32	0.54	0.60
2	808-020	808-020C	3	1 3/32	1 13/32	2 1/2	0.82	0.88
2 1/2	808-025	808-025C	3 9/16	1 9/16	1 9/16	3 1/8	1.34	1.44
3	808-030	808-030C	4 5/16	1 5/8	1 15/16	3 9/16	2.30	2.44
4	808-040	808-040C	5 7/16	1 1 1/16	2 1/2	4 3/16	3.62	3.85

45 DEGREE ELBOW

(SXS)

PVC PART NO. 8309

CPVC PART NO. 8309C

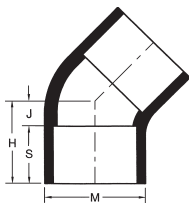

Size	Universal Part Number		M	H	J	S	Approx. Wt. (Lbs.)	
	PVC	CPVC					PVC	CPVC
1/2	817-005	817-005C	1 3/16	1 5/32	1/4	29/32	0.07	0.07
3/4	817-007	817-007C	1 13/32	1 1 1/32	1 5/16	1 1/32	0.10	0.10
1	817-010	817-010C	1 3/4	1 15/32	5/16	1 5/32	0.15	0.16
1 1/4	817-012	817-012C	2 3/32	1 1 1/16	13/32	1 9/32	0.22	0.23
1 1/2	817-015	817-015C	2 1 1/32	1 7/8	1/2	1 3/8	0.30	0.32
2	817-020	817-020C	2 7/8	2 5/32	2 1/32	1 1/2	0.48	0.52
2 1/2	817-025	817-025C	3 15/32	2 1/2	2 3/32	1 25/32	0.81	0.88
3	817-030	817-030C	4 5/32	2 1 1/16	2 5/32	1 29/32	1.16	1.21
4	817-040	817-040C	5 1/4	3 9/16	1 9/32	2 9/32	2.21	2.38
6	817-060	817-060C	7 19/32	5	2	3	5.50	5.85
8	817-080	817-080C	9 1 1/16	6 1/4	2 1/4	4	10.42	10.99

45 DEGREE ELBOW

(FPT X FPT)

PVC PART NO. 8312

CPVC PART NO. 8312C

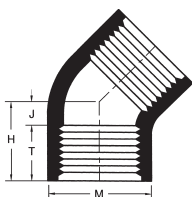

Size	Universal Part Number		M	H	J	T	Approx. Wt. (Lbs.)	
	PVC	CPVC					PVC	CPVC
1/2	819-005	819-005C	1 5/16	1 1/32	9/32	3/4	0.07	0.08
3/4	819-007	819-007C	1 17/32	1 1/8	11/32	25/32	0.10	0.11
1	819-010	819-010C	1 27/32	1 11/32	3/8	31/32	0.16	0.17
1 1/4	819-012	819-012C	2 7/32	1 7/16	7/16	1	0.23	0.25
1 1/2	819-015	819-015C	2 17/32	1 9/16	17/32	1 1/32	0.31	0.33
2	819-020	819-020C	3 1/32	1 3/4	23/32	1 1/32	0.46	0.50
2 1/2	819-025	819-025C	2 9/16	2 1/2	11/16	1 13/16	1.10	1.18
3	819-030	819-030C	4 5/16	2 3/4	7/8	1 7/8	1.74	1.86
4	819-040	819-040C	5 7/16	3 1/4	1 1/8	2 1/8	3.03	3.21

COUPLING

(S X S)

PVC PART NO. 8100

CPVC PART NO. 8100C

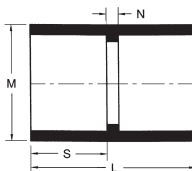

Size	Universal Part Number		L	M	N	S	Approx. Wt. (Lbs.)	
	PVC	CPVC					PVC	CPVC
1/2	829-005	829-005C	1 15/16	1 3/16	1/8	7/8	0.05	0.06
3/4	829-007	829-007C	2 3/16	1 13/32	1/8	1	0.08	0.08
1	829-010	829-010C	2 7/16	1 11/16	1/8	1 1/8	0.12	0.13
1 1/4	829-012	829-012C	2 11/16	2 1/16	1/8	1 1/4	0.17	0.18
1 1/2	829-015	829-015C	2 15/16	2 11/32	1/8	1 3/8	0.23	0.24
2	829-020	829-020C	3 3/16	2 27/32	1/8	1 1/2	0.33	0.34
2 1/2	829-025	829-025C	3 3/4	3 15/32	3/16	1 3/4	0.57	0.61
3	829-030	829-030C	4	4 5/32	3/16	1 7/8	0.81	0.84
4	829-040	829-040C	4 3/4	5 7/32	3/16	2 1/4	1.35	1.46
6	829-060	829-060C	6 9/32	7 1/2	1/4	3	3.34	3.45
8	829-080	829-080C	8 1/4	9 21/32	1/4	4	6.37	6.86

REDUCER COUPLING

(SXS)

PVC PART NO. 8100

CPVC PART NO. 8100C

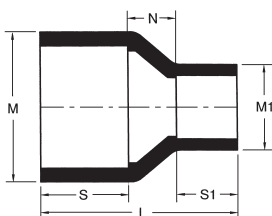

Size	Universal Part Number		L	M	M1
	PVC	CPVC			
3/4 x 1/2	829-101	829-101C	2 3/16	1 3/8	1 3/16
1 x 1/2	829-130	829-130C	2 3/8	1 11/16	1 3/16
1 x 3/4	829-131	829-131C	2 7/16	1 11/16	1 3/8
1 1/4 x 1	829-168	829-168C	2 3/4	2 1/16	1 11/16
1 1/2 x 1	829-211	829-211C	2 7/8	2 3/8	1 11/16
1 1/2 x 1 1/4	829-212	829-212C	2 15/16	2 3/8	2 1/16
2 x 1	829-249	829-249C	3 1/2	2 7/8	1 11/16
2 x 1 1/2	829-251	829-251C	3 3/16	2 7/8	2 3/8
3 x 2	829-338	829-338C	4 1/8	4 1/8	2 7/8
4 x 2	829-420	829-420C	5 1/8	5 1/4	2 7/8
4 x 3	829-422	829-422C	5 1/8	5 1/4	4 7/8
6 x 4	829-532	829-532C	6 5/8	7	5 3/16

Size	N	S	S1	Approx. Wt. (Lbs.)	
				PVC	CPVC
3/4 x 1/2	1/4	1	7/8	0.07	0.08
1 x 1/2	5/16	1 1/8	7/8	0.11	0.11
1 x 3/4	1/4	1 1/8	1	0.11	0.12
1 1/4 x 1	5/16	1 1/4	1 1/8	0.17	0.18
1 1/2 x 1	5/16	1 3/8	1 1/8	0.21	0.22
1 1/2 x 1 1/4	1/4	1 3/8	1 1/4	0.23	0.24
2 x 1	3/8	1 1/2	1 1/8	0.32	0.33
2 x 1 1/2	7/8	1 1/2	1 3/8	0.32	0.34
3 x 2	3/4	1 7/8	1 1/2	0.78	0.84
4 x 2	1 3/16	2 1/4	1 1/2	1.32	1.38
4 x 3	1 5/16	2 1/4	1 7/8	1.38	1.47
6 x 4	1 3/8	3	2 1/4	3.08	3.31

COUPLING

(FPT X FPT)

PVC PART NO. 8102

CPVC PART NO. 8102C

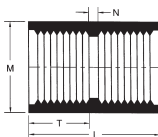

Size	Universal Part Number		L	M	N	T	Approx. Wt. (Lbs.)	
	PVC	CPVC					PVC	CPVC
1/2	830-005	830-005C	1 5/8	1 5/16	3/8	3/4	0.07	0.07
3/4	830-007	830-007C	1 11/16	1 1/2	3/8	25/32	0.09	0.09
1	830-010	830-010C	2 1/16	1 13/16	3/8	31/32	0.14	0.16
1 1/4	830-012	830-012C	2 3/16	2 1/4	3/8	1 1/32	0.23	0.22
1 1/2	830-015	830-015C	2 3/4	2 9/16	3/16	1 1/32	0.28	0.30
2	830-020	830-020C	2 5/16	3	3/16	1 1/16	0.36	0.39
2 1/2	830-025	830-025C	3 5/16	3 9/16	3/16	1 1/16	0.80	0.83
3	830-030	830-030C	3 1/2	4 13/32	3/8	1 11/16	1.09	1.14
4	830-040	830-040C	3 5/8	5 13/32	3/8	1 3/4	1.61	1.70

FEMALE ADAPTER

(S X FPT)

PVC PART NO. 8101

CPVC PART NO. 8101C

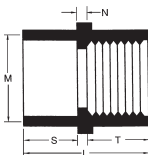

Size	Universal Part Number		L	M	N	T	S	Approx. Wt. (Lbs.)	
	PVC	CPVC						PVC	CPVC
1/2	835-005	835-005C	1 29/32	1 9/32	3/32	29/32	29/32	0.07	0.08
3/4	835-007	835-007C	1 15/16	1 1/2	3/32	13/16	1 1/32	0.10	0.10
1	835-010	835-010C	2 9/32	1 13/16	3/32	1 1/32	1 1/8	0.16	0.08
1 1/4	835-012	835-012C	2 3/8	2 3/16	3/8	1	1 1/4	0.21	0.23
1 1/2	835-015	835-015C	2 9/16	2 7/16	3/8	1 1/32	1 13/32	0.27	0.28
2	835-020	835-020C	2 23/32	3	3/32	1 1/32	1 17/32	0.39	0.41
2 1/2	835-025	835-025C	3 19/32	3 9/16	7/32	1 19/32	1 25/32	0.72	0.73
3	835-030	835-030C	3 3/4	4 1/4	7/32	1 19/32	1 15/16	0.96	0.99
4	835-040	835-040C	4 1/4	5 11/32	1/4	1 3/4	2 1/4	1.52	1.60

MALE ADAPTER

(S X MPT)

PVC PART NO. 8109

CPVC PART NO. 8109C

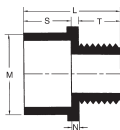

Size	Universal Part Number		L	M	N	S	T	Approx. Wt. (Lbs.)	
	PVC	CPVC						PVC	CPVC
1/2	836-005	836-005C	1 13/16	1 3/16	3/16	7/8	3/4	0.05	0.05
3/4	836-007	836-007C	2 3/8	1 13/32	3/16	1	31/32	0.06	0.06
1	836-010	836-010C	2	1 23/32	1/4	1 1/8	25/32	0.10	0.11
1 1/4	836-012	836-012C	2 1/2	2 3/32	1/4	1 1/4	1	0.15	0.16
1 1/2	836-015	836-015C	2 5/8	2 11/32	1/4	1 3/8	1	0.19	0.20
2	836-020	836-020C	2 7/8	2 7/8	9/32	1 1/2	1 1/16	0.27	0.28
2 1/2	836-025	836-025C	3 11/16	3 19/32	11/32	1 3/4	1 1/16	0.50	0.53
3	836-030	836-030C	3 7/8	4 5/32	3/8	1 7/8	1 5/8	0.71	0.75
4	836-040	836-040C	4 1/2	5 3/8	7/16	2 1/4	1 25/32	1.38	1.46

REDUCER BUSHING

(FLUSH STYLE) (SPG X S)

PVC PART NO. 8107

CPVC PART NO. 8107C

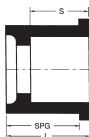

Size	Universal Part Number		L	SPG	S	Approx. Wt. (Lbs.)	
	PVC	CPVC				PVC	CPVC
3/4 x 1/2	837-101	837-101C	1 9/32	1 1/32	7/8	0.02	0.03
1 x 1/2	837-130	837-130C	1 13/32	1 5/32	7/8	0.06	0.07
1 x 3/4	837-131	837-131C	1 13/32	1 5/32	1	0.04	0.05
1 1/4 x 1/2	837-166	837-166C	1 1/2	1 1/4	7/8	0.11	0.12
1 1/4 x 3/4	837-167	837-167C	1 1/2	1 1/4	1	0.11	0.12
1 1/4 x 1	837-168	837-168C	1 19/32	1 9/32	1 1/8	0.08	0.08
1 1/2 x 1/2	837-209	837-209C	1 23/32	1 13/32	7/8	0.15	0.16
1 1/2 x 3/4	837-210	837-210C	1 23/32	1 13/32	1	0.19	0.20
1 1/2 x 1	837-211	837-211C	1 23/32	1 13/32	1 1/8	0.14	0.15
1 1/2 x 1 1/4	837-212	837-212C	1 23/32	1 13/32	1 1/4	0.08	0.09
2 x 1/2	837-247	837-247C	1 7/8	1 1/2	7/8	0.22	0.23
2 x 3/4	837-248	837-248C	1 7/8	1 1/2	1	0.21	0.24
2 x 1	837-249	837-249C	1 7/8	1 1/2	1 1/8	0.24	0.26
2 x 1 1/4	837-250	837-250C	1 7/8	1 1/2	1 1/4	0.24	0.25
2 x 1 1/2	837-251	837-251C	1 29/32	1 1/2	1 3/8	0.17	0.18
2 1/2 x 1 1/2	837-291	837-291C	2 5/32	1 3/4	1 3/8	0.39	0.43
2 1/2 x 2	837-292	837-292C	2 5/32	1 3/4	1 1/2	0.27	0.29
3 x 1 1/2	837-337	837-337C	2 1/4	1 29/32	1 3/8	0.64	0.69
3 x 2	837-338	837-338C	2 1/4	1 29/32	1 1/2	0.57	0.62
3 x 2 1/2	837-339	837-339C	2 1/4	1 29/32	1 3/4	0.42	0.44
4 x 2	837-420	837-420C	2 25/32	2 5/16	1 1/2	1.04	1.15
4 x 3	837-422	837-422C	2 25/32	2 5/16	1 7/8	0.76	0.82
6 x 3	837-530	837-530C	3 17/32	3 1/32	1 7/8	2.60	2.78
6 x 4	837-532	837-532C	3 17/32	3 1/32	2 1/4	2.50	2.69
8 x 6	837-585	837-585C	4 15/16	4 1/32	3 1/16	5.52	5.86

REDUCER BUSHING

(FLUSH STYLE)

(SPG X FPT)

PVC PART NO. 8108

CPVC PART NO. 8108C

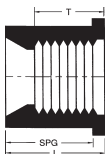

Size	Universal Part Number		L	SPG	T	Approx. Wt. (Lbs.)	
	PVC	CPVC				PVC	CPVC
3/4 x 1/2	838-101	838-101C	1 1/4	1 1/32	3/4	0.03	0.03
1 x 1/2	838-130	838-130C	1 7/16	1 5/32	3/4	0.06	0.07
1 x 3/4	838-131	838-131C	1 3/8	1 5/32	25/32	0.05	0.05
1 1/4 x 1	838-168	838-168C	1 9/16	1 9/32	1	0.09	0.09
1 1/2 x 3/4	838-210	838-210C	1 3/4	1 13/32	25/32	0.16	0.17
1 1/2 x 1	838-211	838-211C	1 3/4	1 13/32	1 1/32	0.15	0.15
1 1/2 x 1 1/4	838-212	838-212C	1 21/32	1 13/32	1	0.10	0.11
2 x 3/4	838-248	838-248C	1 7/8	1 17/32	25/32	0.23	0.24
2 x 1	838-249	838-249C	1 7/8	1 17/32	1 1/32	0.27	0.30
2 x 1 1/4	838-250	838-250C	1 29/32	1 17/32	1	0.24	0.26
2 x 1 1/2	838-251	838-251C	1 29/32	1 17/32	1 1/32	0.19	0.20
2 1/2 x 1 1/2	838-291	838-291C	2 3/16	1 25/32	1 1/32	0.42	0.46
2 1/2 x 2	838-292	838-292C	2 3/16	1 25/32	1 1/32	0.31	0.32
3 x 2	838-338	838-338C	2 9/32	1 29/32	1 1/16	0.62	0.67
3 x 2 1/2	838-339	838-339C	2 9/32	1 29/32	1 7/16	0.49	0.52
4 x 2	838-420	838-420C	2 11/16	2 5/16	1	1.11	1.22
4 x 3	838-422	838-422C	2 11/16	2 5/16	1 5/8	0.86	0.92

REDUCER BUSHING

(FLUSH STYLE)

(MPT X FPT)

PVC PART NO. 8200

CPVC PART NO. 8200C

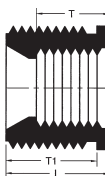

Size	Universal Part Number		L	T	T1	Approx. Wt. (Lbs.)	
	PVC	CPVC				PVC	CPVC
3/4 x 1/2	839-101	839-101C	1	23/32	3/4	0.02	0.02
1 x 1/2	839-130	839-130C	1 1/4	31/32	3/4	0.05	0.06
1 x 3/4	839-131	839-131C	1 1/4	31/32	3/4	0.04	0.05
1 1/4 x 1	839-168	839-168C	1 5/16	1	1	0.06	0.07
1 1/2 x 1	839-211	839-211C	1 3/8	1 1/16	1	0.11	0.12
1 1/2 x 1 1/4	839-212	839-212C	1 3/8	1 1/16	1	0.07	0.07
2 x 1	839-249	839-249C	1 7/16	1 1/8	1	0.19	0.20
2 x 1 1/2	839-251	839-251C	1 7/16	1 1/8	1	0.13	0.14
2 1/2 x 2	839-292	839-292C	1 15/16	1 9/16	1	0.24	0.26
3 x 2	839-338	839-338C	2	1 5/8	1	0.51	0.55
3 x 2 1/2	839-339	839-339C	2	1 9/16	1 5/8	0.38	0.40
4 x 2	839-420	839-420C	2 11/16	1	2 5/16	0.99	1.11

CAP
(S)

PVC PART NO. 8116

CPVC PART NO. 8116C



Size	Universal Part Number		M	S	L	Approx. Wt. (Lbs.)	
	PVC	CPVC				PVC	CPVC
1/2	847-005	847-005C	1 3/16	7/8	1 3/8	0.04	0.04
3/4	847-007	847-007C	1 13/32	1	1 15/32	0.06	0.06
1	847-010	847-010C	1 11/16	1 1/8	1 5/8	0.09	0.10
1 1/4	847-012	847-012C	2 1/16	1 1/4	1 13/16	0.15	0.16
1 1/2	847-015	847-015C	2 11/32	1 3/8	2	0.18	0.19
2	847-020	847-020C	2 27/32	1 1/2	2 5/32	0.28	0.29
2 1/2	847-025	847-025C	3 15/32	1 3/4	2 19/32	0.48	0.52
3	847-030	847-030C	4 5/32	1 7/8	2 13/16	0.70	0.74
4	847-040	847-040C	5 7/32	2 1/4	3 5/16	1.20	1.28
6	847-060	847-060C	7 1/2	3	4 11/16	3.10	3.34
8	847-080	847-080C	9 21/32	4	6 7/16	6.11	6.37

CAP
(FPT)

PVC PART NO. 8117

CPVC PART NO. 8117C

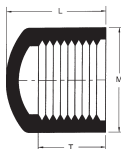

Size	Universal Part Number		M	T	L	Approx. Wt. (Lbs.)	
	PVC	CPVC				PVC	CPVC
1/2	848-005	848-005C	1 9/32	3/4	1 1/32	0.05	0.05
3/4	848-007	848-007C	1 1/2	7/8	1 7/32	0.07	0.07
1	848-010	848-010C	1 13/16	1	1 3/8	0.10	0.10
1 1/4	848-012	848-012C	2 7/32	1	1 17/32	0.15	0.16
1 1/2	848-015	848-015C	2 15/32	1 1/32	1 5/8	0.19	0.20
2	848-020	848-020C	3	1 1/32	1 13/16	0.29	0.31
2 1/2	848-025	848-025C	3 19/32	1 5/16	2 15/32	0.54	0.57
3	848-030	848-030C	4 5/16	1 7/16	2 23/32	0.80	0.85
4	848-040	848-040C	5 3/8	1 1/2	3	1.30	1.40

PLUG
(MPT)

PVC PART NO. 8113
CPVC PART NO. 8113C



Size	Universal Part Number		L	T	Approx. Wt. (Lbs.)	
	PVC	CPVC			PVC	CPVC
1/2	850-005	850-005C	1 5/16	3/4	0.02	0.02
3/4	850-007	850-007C	1	3/4	0.03	0.03
1	850-010	850-010C	1 1/4	1	0.05	0.05
1 1/4	850-012	850-012C	1 5/16	1	0.07	0.08
1 1/2	850-015	850-015C	1 5/16	1	0.10	0.11
2	850-020	850-020C	1 1/2	1 1/16	0.18	0.20

FLANGE**
(ONE PIECE)
(S)

PVC PART NO. 8500
CPVC PART NO. 8500C

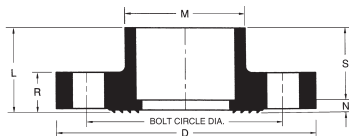

Size	Universal Part Number		D	L	M	N	S	CIRCLE R
	PVC	CPVC						
1/2	851-005	851-005C	3 1/2	1 1/8	1 3/16	7/32	29/32	9/16
3/4	851-007	851-007C	3 7/8	1 3/16	1 13/32	3/16	1	9/16
1	851-010	851-010C	4 1/4	1 5/16	1 23/32	3/16	1 1/8	5/8
1 1/4	851-012	851-012C	4 19/32	1 7/16	2 3/32	3/16	1 1/4	11/16

Size	BOLT CIRCLE DIA.	BOLT HOLE DIA.	NO. OF BOLT HOLES	BOLT DIA.	MIN. BOLT LENGTH*	Approx. Wt. (Lbs.)	
						PVC	CPVC
1/2	2 3/8	5/8	4	1/2	2 1/4	0.18	0.19
3/4	2 3/4	5/8	4	1/2	2 1/4	0.25	0.26
1	3 1/8	5/8	4	1/2	2 1/4	0.33	0.35
1 1/4	3 1/2	5/8	4	1/2	2 1/2	0.43	0.45

* BOLT LENGTHS WERE CALCULATED USING TWO CHARLOTTE FLANGES. LENGTHS MAY VARY WHEN MATING WITH OTHER BRANDS OR ACCESSORIES.

** THE MAXIMUM WORKING PRESSURE IS 150 PSI AT 73°F.

FLANGE**

(ONE PIECE)
(FPT)

PVC PART NO. 8560
CPVC PART NO. 8560C

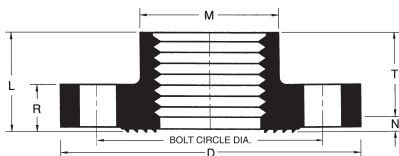

Size	Universal Part Number		D	L	M	N	T	R
	PVC	CPVC						
1/2	852-005	852-005C	3 1/2	1	1 1/16	1/4	3/4	9/16
3/4	852-007	852-007C	3 7/8	1	1 1/2	3/16	13/16	19/32
1	852-010	852-010C	4 1/4	1 1/8	1 13/16	1/8	1	21/32
1 1/4	852-012	852-012C	4 19/32	1 7/32	2 7/32	7/32	1	23/32
1 1/2	852-015	852-015C	5	1 1/4	2 1/2	1/4	1	13/16
2	852-020	852-020C	6	1 3/4	3 1/32	3/8	1 3/8	13/16

Size	BOLT CIRCLE DIA.	BOLT HOLE DIA.	NO. OF BOLT HOLES	BOLT DIA.	MIN. BOLT LENGTH*	Approx. Wt. (Lbs.)	
						PVC	CPVC
1/2	2 3/8	5/8	4	1/2	2 1/4	0.19	0.20
3/4	2 3/4	5/8	4	1/2	2 1/4	0.25	0.26
1	3 1/8	5/8	4	1/2	2 1/4	0.33	0.35
1 1/4	3 1/2	5/8	4	1/2	2 1/2	0.44	0.46
1 1/2	3 7/8	5/8	4	1/2	2 1/2	0.57	0.60
2	4 3/4	5/8	4	5/8	3	0.92	0.97

* BOLT LENGTHS WERE CALCULATED USING TWO CHARLOTTE FLANGES.
LENGTHS MAY VARY WHEN MATING WITH OTHER BRANDS OR ACCESSORIES.
** THE MAXIMUM WORKING PRESSURE IS 150 PSI AT 73°F.

BLIND FLANGE**

(ONE PIECE)

PVC PART NO. 8510
CPVC PART NO. 8510C

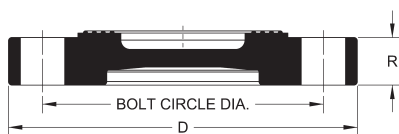

Size	Universal Part Number		D	R
	PVC	CPVC		
2	853-020	853-020C	5 7/8	13/16
3	853-030	853-030C	7 7/16	29/32
4	853-040	853-040C	9 1/32	1 1/16
8	853-080	853-080C	13 1/2	1 19/32

Size	BOLT CIRCLE DIA.	BOLT HOLE DIA.	NO. OF BOLT HOLES	BOLT DIA.	MIN. BOLT LENGTH*	Approx. Wt. (Lbs.)	
						PVC	CPVC
2	4 3/4	3/4	4	5/8	3	0.84	0.90
3	6	3/4	4	5/8	3 3/4	1.58	1.73
4	7 1/2	3/4	8	5/8	3 1/2	2.50	2.75
8	11 23/32	19/16	8	3/4	4 1/2	7.83	8.43

* BOLT LENGTHS WERE CALCULATED USING TWO CHARLOTTE FLANGES.
LENGTHS MAY VARY WHEN MATING WITH OTHER BRANDS OR ACCESSORIES.
** THE MAXIMUM WORKING PRESSURE IS 150 PSI AT 73°F.

VAN STONE FLANGE**

(S)

PVC PART NO. 8530

CPVC PART NO. 8530C

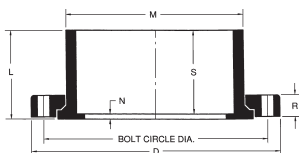

Size	Universal Part Number		D	L	M	N	S	R
	PVC	CPVC						
1 1/2	854-015	854-015C	4 15/16	1 9/16	2 7/16	3/32	1 15/32	23/32
2	854-020	854-020C	5 7/8	1 23/32	2 27/32	3/32	1 19/32	13/16
2 1/2	854-025	854-025C	6 11/16	1 31/32	3 15/32	1/8	1 27/32	29/32
3	854-030	854-030C	7 7/16	2 1/8	4 5/32	1/8	1 15/16	29/32
4	854-040	854-040C	9 1/32	2 5/8	5 1/4	1/8	2 5/16	1 1/16
6	854-060	854-060C	10 31/32	3 7/32	7 9/16	1/8	3 3/32	1 7/32
8	854-080	854-080C	13 11/32	4 5/16	9 11/16	3/16	4 5/32	1 1/2
10	854-100	854-100C	16	5 11/16	11 3/4	5/8	5 1/32	1 11/16
12	854-120	854-120C	19	7 5/16	13 23/32	9/16	6 3/4	1 11/16

Size	BOLT CIRCLE DIA.	BOLT HOLE DIA.	NO. OF BOLT HOLES	BOLT DIA.	MIN. BOLT LENGTH*	Approx. Wt. (Lbs.)	
						PVC	CPVC
1 1/2	3 7/8	5/8	4	1/2	2 1/2	0.54	0.59
2	4 3/4	3/4	4	5/8	3	0.81	0.88
2 1/2	5 1/2	3/4	4	5/8	3 1/4	1.27	1.34
3	6	3/4	4	5/8	3 1/4	1.60	1.64
4	7 1/2	3/4	8	5/8	3 1/2	2.51	2.53
6	9 1/2	31/32	8	3/4	4	3.88	3.98
8	11 3/4	29/32	8	3/4	4 1/2	7.21	7.42
10	14 1/4	1	12	7/8	5	11.74	12.26
12	17	1	12	7/8	5	18.08	18.67

* BOLT LENGTHS WERE CALCULATED USING TWO CHARLOTTE FLANGES. LENGTHS MAY VARY WHEN MATING WITH OTHER BRANDS OR ACCESSORIES.

** THE MAXIMUM WORKING PRESSURE IS 150 PSI AT 73°F.

UNION*

(WITH VITON® O-RING SEAL)

(S)

PVC PART NO. 8700

CPVC PART NO. 8700C

UNION*

(WITH EPDM O-RING SEAL)

(S)

PVC PART NO. 8710

CPVC PART NO. 8710C

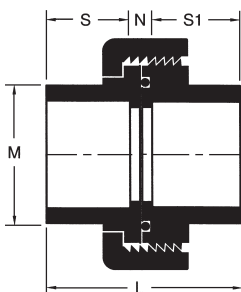

Size	Universal Part Number		PVC	CPVC
	w/Viton O-Ring Seal	w/EPDM O-Ring Seal		
	PVC	CPVC		
1/2	857-005	857-005C	897-005	897-005C
3/4	857-007	857-007C	897-007	897-007C
1	857-010	857-010C	897-010	897-010C
1 1/4	857-012	857-012C	897-012	897-012C
1 1/2	857-015	857-015C	897-015	897-015C
2	857-020	857-020C	897-020	897-020C
3	857-030	857-030C	897-030	897-030C

Size	L	M	N	S	S1	Approx. Wt. (Lbs.)	
						PVC	CPVC
1/2	2 1/8	1 9/32	5/16	29/32	29/32	0.18	0.19
3/4	2 7/16	1 1/2	7/16	1	1	0.26	0.28
1	2 5/8	1 13/16	3/8	1 1/8	1 1/8	0.36	0.38
1 1/4	2 15/16	2 1/8	7/16	1 1/4	1 1/4	0.52	0.55
1 1/2	3 3/16	2 3/8	7/16	1 3/8	1 3/8	0.57	0.60
2	3 21/32	2 7/8	21/32	1 1/2	1 1/2	0.90	0.95
3	5 1/8	4 3/16	1 5/16	1 29/32	1 29/32	2.22	2.36

* THE MAXIMUM WORKING PRESSURE IS 235 PSI AT 73°F.

UNION*

(WITH VITON® O-RING SEAL)

(FPT)

PVC PART NO. 8800

CPVC PART NO. 8800C

UNION*

(WITH EPDM O-RING SEAL)

(FPT)

PVC PART NO. 8810

CPVC PART NO. 8810C

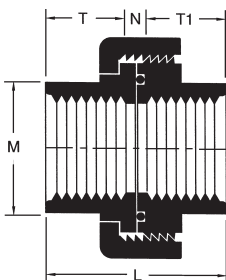

Size	Universal Part Number		PVC	CPVC
	w/Viton O-Ring Seal	w/EPDM O-Ring Seal		
	PVC	CPVC		
1/2	858-005	858-005C	898-005	898-005C
3/4	858-007	858-007C	898-007	898-007C
1	858-010	858-010C	898-010	898-010C
1 1/4	858-012	858-012C	898-012	898-012C
1 1/2	858-015	858-015C	898-015	898-015C
2	858-020	858-020C	898-020	898-020C
3	858-030	858-030C	898-030	898-030C

Size	L	M	N	T	T1	Approx. Wt. (Lbs.)	
						PVC	CPVC
1/2	2 3/16	1 1/4	1/2	15/16	3/4	0.19	0.21
3/4	2 13/32	1 1/2	9/16	1 3/32	3/4	0.28	0.29
1	2 5/8	1 13/16	9/16	1 3/32	33/32	0.40	0.42
1 1/4	2 31/32	2 1/8	23/32	1 1/4	1	0.58	0.61
1 1/2	3 1/8	2 1/2	23/32	1 11/32	1 1/16	0.67	0.71
2	3 5/8	3	27/32	1 19/32	1 3/16	1.03	1.09
3	5 1/8	4 9/32	1 3/4	1 11/16	1 11/16	2.49	2.64

* THE MAXIMUM WORKING PRESSURE IS 235 PSI AT 73°F.

PVC Schedule 40 Pipe



PVC Schedule 40 Pipe - Plain End

PVC SCHEDULE 40 (WHITE)			PLAIN END	PVC 1120	ASTM D 1785	
PART NO.	NOM. SIZE	UPC # 611942-	AVG. OD (IN.)	MIN. WALL (IN.)	MAX WORK PRESSURE AT 23° C OR 73° F	WT. PER 100 FT. (LBS.)
PVC 4005	½" x 10'	06658	.840	.109	600 PSI	15.9
PVC 4005	½" x 20'	03922	.840	.109	600 PSI	15.9
PVC 4007	¾" x 10'	06661	1.050	.113	480 PSI	21.1
PVC 4007	¾" x 20'	03925	1.050	.113	480 PSI	21.1
PVC 4010	1" x 10'	06664	1.315	.133	450 PSI	31.3
PVC 4010	1" x 20'	03928	1.315	.133	450 PSI	31.3
PVC 7100*	1¼" x 10'	03945	1.660	.140	370 PSI	42.4
PVC 7100*	1¼" x 20'	03946	1.660	.140	370 PSI	42.4
PVC 7112*	1½" x 10'	03947	1.900	.145	330 PSI	50.7
PVC 7112*	1½" x 20'	03948	1.900	.145	330 PSI	50.7
PVC 7200*	2" x 10'	03949	2.375	.154	280 PSI	68.1
PVC 7200*	2" x 20'	03950	2.375	.154	280 PSI	68.1
PVC 4025*	2½" x 20'	04205	2.875	.203	300 PSI	108.0
PVC 7300*	3" x 10'	03951	3.500	.216	260 PSI	141.2
PVC 7300*	3" x 20'	03952	3.500	.216	260 PSI	141.2
PVC 7400*	4" x 10'	03953	4.500	.237	220 PSI	201.2
PVC 7400*	4" x 20'	03954	4.500	.237	220 PSI	201.2
PVC 7500*	5" x 20'	04837	5.563	.258	190 PSI	272.5
PVC 7600*	6" x 10'	03955	6.625	.280	180 PSI	353.7
PVC 7600*	6" x 20'	03956	6.625	.280	180 PSI	353.7
PVC 7800*	8" x 20'	03958	8.625	.322	160 PSI	532.3
PVC 7910*	10" x 20'	03959	10.750	.365	140 PSI	754.7
PVC 7912*	12" x 20'	03961	12.750	.406	130 PSI	997.9
PVC 7914*	14" x 20'	04862	14.000	.437	130 PSI	1180.1
PVC 7916*	16" x 20'	04918	16.000	.500	130 PSI	1543.1

* Dual Marked ASTM D 1785 & ASTM D 2665.

Note: When ordering, please specify plain end or bell end.

NSF Listed. Meets All Requirements of ASTM D 1784 and ASTM D 1785.

PVC piping products are not recommended for use with compressed air or gases.



PVC Schedule 40 Pipe - Bell End*

PVC SCHEDULE 40 (WHITE)			BELL END	PVC 1120		ASTM D 1785	
PART NO.	NOM. SIZE	UPC # 611942-	AVG. OD (IN.)	MIN. WALL (IN.)	MAX WORK PRESSURE AT 23° C OR 73° F	BELL DEPTH (IN.)	WT. PER 100 FT. (LBS.)
PVC 4005B**	½"x10'	04986	.840	.109	600 PSI	2.00	15.9
PVC 4005B**	½"x20'	03923	.840	.109	600 PSI	2.00	15.9
PVC 4007B**	¾"x10'	04987	1.050	.113	480 PSI	2.25	21.1
PVC 4007B**	¾"x20'	03926	1.050	.113	480 PSI	2.25	21.1
PVC 4010B**	1"x10'	04988	1.315	.133	450 PSI	2.50	31.3
PVC 4010B**	1"x20'	03929	1.315	.133	450 PSI	2.50	31.1
PVC 4012B§	1¼"x10'	04989	1.660	.140	370 PSI	2.75	42.4
PVC 4012B§	1¼"x20'	03930	1.660	.140	370 PSI	2.75	42.4
PVC 4015B§	1½"x10'	04990	1.900	.145	330 PSI	3.00	50.7
PVC 4015B§	1½"x20'	03931	1.900	.145	330 PSI	3.00	50.7
PVC 4020B†	2"x10'	04991	2.375	.154	280 PSI	4.00	69.2
PVC 4020B†	2"x20'	03932	2.375	.154	280 PSI	4.00	69.2
PVC 4025B‡	2½"x10'	04992	2.875	.203	300 PSI	4.00	110.0
PVC 4025B‡	2½"x20'	04206	2.875	.203	300 PSI	4.00	110.0
PVC 7300B§	3"x10'	04853	3.500	.216	260 PSI	4.00	145.1
PVC 4030B†	3"x20'	03933	3.500	.216	260 PSI	4.00	144.5
PVC 7400B§	4"x10'	04835	4.500	.237	220 PSI	4.00	207.9
PVC 9400B†	4"x20'	03964	4.500	.237	220 PSI	5.00	206.2
PVC 7600B§	6"x10'	04850	6.625	.280	180 PSI	6.50	371.4
PVC 9600B†	6"x20'	03965	6.625	.280	180 PSI	6.50	365.5
PVC 7800B†	8"x10'	09903	8.625	.322	160 PSI	7.00	556.9
PVC 9800B†	8"x20'	03967	8.625	.322	160 PSI	7.00	552.3
PVC 7912B†	12"x20'	03962	12.750	.406	130 PSI	10.00	1046.7
PVC 7914B†	14"x20'	04863	14.000	.437	130 PSI	10.00	1180.1
PVC 7916B†	16"x20'	04929	16.000	.500	130 PSI	10.00	1543.1

* Bell dimensions meet either ASTM D 2672 or
ASTM F 480, depending upon pipe diameter

** ASTM D 1785

§ Dual Marked ASTM D 1785 & ASTM D 2665

† Triple Marked ASTM D 1785 & ASTM D 2665 &
ASTM F 480

‡ Dual Marked ASTM D 1785 & ASTM F 480

PVC piping products are not recommended for use with compressed air or gases.



PVC Well Casing

PVC SCHEDULE 40 (WHITE) BELL END WELL CASING PVC 1120 ASTM F 480						
PART NO.	NOM. SIZE	UPC # 611942-	AVG. OD (IN.)	MIN. WALL (IN.)	BELL DEPTH (IN.)	WT. PER 100 FT. (LBS.)
PVC 4020B	2"x20'	03932	2.375	.154	4.00	69.2
PVC 4025B	2½"x20'	04206	2.875	.203	4.00	110.0
PVC 4030B	3"x20'	03933	3.500	.216	4.00	144.5
PVC 9400B	4"x20'	03964	4.500	.237	5.00	206.2
PVC 9600B	6"x20'	03965	6.625	.280	6.50	365.5
PVC 9800B	8"x20'	03967	8.625	.322	7.00	552.3

SDR 17 and DR 27.6 BELL END WELL CASING PVC 1120 ASTM F 480						
PART NO.	NOM. SIZE	UPC # 611942-	AVG. OD (IN.)	MIN. WALL (IN.)	BELL DEPTH (IN.)	WT. PER 100 FT. (LBS.)
PVC 9450B	4½"x20'	04159	SDR 17	4.950	.291	278.4

PVC SDR Pipe

PR 200	PVC 1120	BELL END	ASTM D 2241		SDR 21		
PART NO.	NOM. SIZE	UPC # 611942-	AVG. OD (IN.)	MIN. WALL (IN.)	MAX WORK PRESSURE AT 23° C OR 73° F	BELL DEPTH (IN.)	WT. PER 100 FT. (LBS.)
PVC 23155B	*¾"x20'	03991	.840	.062	315 PSI	2.00	10.0
PVC 20007B	¾"x10'	10742	1.050	.060	200 PSI	2.25	11.8
PVC 20007B	¾"x20'	03984	1.050	.060	200 PSI	2.25	11.8
PVC 20010B	1"x20'	03986	1.315	.063	200 PSI	2.50	15.7
PVC 20012B	1¼"x20'	03987	1.660	.079	200 PSI	2.75	24.9
PVC 20015B	1½"x20'	03988	1.900	.090	200 PSI	3.00	32.4
PVC 20020B	2"x20'	03989	2.375	.113	200 PSI	4.00	50.9

*PR 315 / SDR 13.5

PR 160	PVC 1120	BELL END	ASTM D 2241		SDR 26		
PART NO.	NOM. SIZE	UPC # 611942-	AVG. OD (IN.)	MIN. WALL (IN.)	MAX WORK PRESSURE AT 23° C OR 73° F	BELL DEPTH (IN.)	WT. PER 100 FT. (LBS.)
PVC 16012B	1¼"x20'	04211	1.660	.064	160 PSI	2.75	20.3
PVC 16015B	1½"x20'	04210	1.900	.073	160 PSI	3.00	26.6
PVC 16020B	2"x20'	04212	2.375	.091	160 PSI	4.00	41.4
PVC 16030B	3"x20'	04222	3.500	.135	160 PSI	4.00	92.3

Note: When ordering, please specify plain end or bell end.

PVC piping products are not recommended for use with compressed air or gases.



TEE
 (SXSXS)

PVC PART NO. 2400

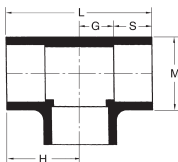

Size	Universal Part Number	L	M	H	G	S	Approx. Wt. (Lbs)
1/2	401-005	2 1/2	1 3/32	1 1/4	1/2	3/4	0.067
3/4	401-007	2 9/16	1 9/32	1 9/32	9/16	23/32	0.079
1	401-010	3 1/8	1 19/32	1 9/16	11/16	7/8	0.136
1 1/4	401-012	4 1/4	2	2 1/8	7/8	1 1/4	0.307
1 1/2	401-015	4 5/8	2 1/4	2 5/16	1	1 5/16	0.340
2	401-020	5 1/4	2 3/4	2 5/8	1 1/4	1 3/8	0.412
2 1/2	401-025	6 1/2	3 5/16	3 1/4	1 1/2	1 3/4	0.944
3	401-030	7 5/8	3 31/32	3 13/16	1 13/16	2	1.422
4	401-040	8 3/4	5	4 3/8	2 5/16	2 1/16	2.212
6	401-060	14	7 5/16	7	3 1/2	3 1/2	7.158
8	401-080	17 1/16	9 5/16	8 17/32	4 1/2	4 1/32	12.332

REDUCING TEE
(SXSXS)

PVC PART NO. 2400

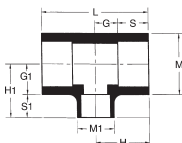

Size	Universal Part Number	L	M	H
1/2 x 1/2 x 3/4	401-074	2 7/8	1 1/16	1 7/16
3/4 x 1/2 x 3/4	401-095	3 1/4	1 5/16	1 3/4
3/4 x 3/4 x 1/2	401-101	3 1/8	1 11/32	1 9/16
3/4 x 3/4 x 1	401-102	3 5/8	1 5/16	1 13/16
1 x 1 x 1/2	401-130	3 3/8	1 5/8	1 11/16
1 x 1 x 3/4	401-131	3 9/16	1 19/32	1 25/32
1 1/4 x 1 1/4 x 1/2	401-166	3 1/2	2	1 3/4
1 1/4 x 1 1/4 x 3/4	401-167	3 13/16	2	1 29/32
1 1/4 x 1 1/4 x 1	401-168	4 1/16	2	2 1/32
1 1/2 x 1 1/2 x 1/2	401-209	3 3/4	2 1/4	1 7/8
1 1/2 x 1 1/2 x 3/4	401-210	3 15/16	2 1/4	2
1 1/2 x 1 1/2 x 1	401-211	4 1/4	2 1/4	2 1/8
1 1/2 x 1 1/2 x 1 1/4	401-212	4 5/8	2 1/4	2 5/16
2 x 2 x 3/4	401-248	4	2 23/32	2
2 x 2 x 1	401-249	4 3/8	2 23/32	2 3/16
2 x 2 x 1 1/4	401-250	4 3/4	2 23/32	2 3/8
2 x 2 x 1 1/2	401-251	5	2 23/32	2 1/2
3 x 3 x 2	401-338	6 11/16	3 3/32	3 11/32
4 x 4 x 2	401-420	6 13/16	5 1/32	3 13/32
4 x 4 x 3	401-422	8 1/8	5	4 1/16
6 x 6 x 4	401-532	12 1/16	7 1/4	6 1/32

Size	G	S	M1	H1	G1	S1	Approx. Wt. (Lbs)
1/2 x 1/2 x 3/4	11/16	3/4	1 1/16	1 7/16	11/16	3/4	0.082
3/4 x 1/2 x 3/4	3/4	1	1 3/32	1 1/2	3/4	1	0.106
3/4 x 3/4 x 1/2	9/16	1	1 11/32	1 9/16	9/16	1	0.106
3/4 x 3/4 x 1	13/16	1	1 5/16	1 13/16	13/16	1	0.134
1 x 1 x 1/2	9/16	1 1/8	1 5/8	1 11/16	9/16	1 1/8	0.134
1 x 1 x 3/4	5/8	1 5/32	1 19/32	1 25/32	5/8	1 5/32	0.148
1 1/4 x 1 1/4 x 1/2	1/2	1 1/4	2	1 3/4	1/2	1 1/4	0.196
1 1/4 x 1 1/4 x 3/4	21/32	1 1/4	2	1 29/32	21/32	1 1/4	0.226
1 1/4 x 1 1/4 x 1	25/32	1 1/4	2	2 1/32	25/32	1 1/4	0.256
1 1/2 x 1 1/2 x 1/2	9/16	1 5/16	2 1/4	1 7/8	9/16	1 5/16	0.238
1 1/2 x 1 1/2 x 3/4	11/16	1 5/16	2 1/4	2	11/16	1 5/16	0.256
1 1/2 x 1 1/2 x 1	13/16	1 5/16	2 1/4	2 1/8	13/16	1 5/16	0.294
1 1/2 x 1 1/2 x 1 1/4	1	1 5/16	2 1/4	2 5/16	1	1 5/16	0.338
2 x 2 x 3/4	5/8	1 3/8	2 23/32	2	5/8	1 3/8	0.320
2 x 2 x 1	13/16	1 3/8	2 23/32	2 3/16	13/16	1 3/8	0.383
2 x 2 x 1 1/4	1	1 3/8	2 23/32	2 3/8	1	1 3/8	0.436
2 x 2 x 1 1/2	1 1/8	1 3/8	2 23/32	2 1/2	1 1/8	1 3/8	0.462
3 x 3 x 2	1 11/32	2	3 31/32	3 11/32	1 11/32	2	1.100
4 x 4 x 2	1 11/32	2 1/16	5 1/32	3 13/32	1 11/32	2 1/16	1.594
4 x 4 x 3	2	2 1/16	5	4 1/16	2	2 1/16	1.982
6 x 6 x 4	2 17/32	3 1/2	7 1/4	6 1/32	2 17/32	3 1/2	4.900

SCHEDULE 40 FITTINGS

TEE

(SX SX FPT)

PVC PART NO. 2401

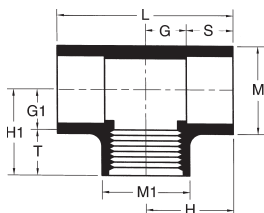

Size	Universal Part Number	L	M	H
1/2	402-005	2 9/16	1 3/32	1 9/32
3/4	402-007	3 5/16	1 11/32	1 23/32
1	402-010	3 13/16	1 19/32	1 29/32
1 1/4	402-012	4 15/32	1 31/32	2 1/4
1 1/2	402-015	4 7/8	2 7/32	2 7/16
2	402-020	5 1/2	2 23/32	2 3/4

Size	G	S	M1	H1	G1	T	Approx. Wt. (Lbs)
1/2	17/32	3/4	1 3/32	1 9/32	17/32	3/4	0.075
3/4	21/32	1	1 11/32	1 13/32	19/32	13/16	0.130
1	25/32	1 1/8	1 19/32	1 29/32	29/32	1	0.184
1 1/4	1	1 1/4	1 31/32	2 1/4	1	1 1/4	0.292
1 1/2	1 1/8	1 5/16	2 1/4	2 7/16	1 5/32	1 1/4	0.408
2	1 3/8	1 3/8	2 23/32	2 3/8	1 9/16	1 3/16	0.552

REDUCING TEE
(S X S X FPT)

PVC PART NO. 2401

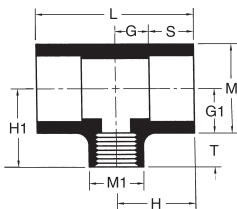

Size	Universal Part Number	L	M	H
3/4 x 3/4 x 1/2	402-101	3 1/8	1 11/32	1 9/16
1 x 1 x 1/2	402-130	3 5/16	1 19/32	1 21/32
1 x 1 x 3/4	402-131	3 9/16	1 19/32	1 25/32
1 1/4 x 1 1/4 x 1/2	402-166	3 9/16	1 31/32	1 25/32
1 1/4 x 1 1/4 x 3/4	402-167	3 13/16	1 31/32	1 29/32
1 1/4 x 1 1/4 x 1	402-168	4 1/8	1 31/32	2 1/16
1 1/2 x 1 1/2 x 1/2	402-209	3 1/2	2 1/4	1 3/4
1 1/2 x 1 1/2 x 3/4	402-210	3 15/16	2 1/4	1 33/32
1 1/2 x 1 1/2 x 1	402-211	4 1/4	2 1/4	2 3/8
2 x 2 x 1	402-249	4 3/8	2 23/32	2 3/16
2 x 2 x 1 1/4	402-250	4 3/4	2 23/32	2 3/8

Size	G	S	M1	H1	G1	T	Approx. Wt. (Lbs)
3/4 x 3/4 x 1/2	9/16	1	1 3/32	1 13/32	21/32	3/4	0.122
1 x 1 x 1/2	17/32	1 1/8	1 3/32	1 17/32	25/32	3/4	0.142
1 x 1 x 3/4	21/32	1 1/8	1 5/16	1 25/32	1 1/32	3/4	0.158
1 1/4 x 1 1/4 x 1/2	17/32	1 1/4	1 1/16	1 23/32	1	23/32	0.202
1 1/4 x 1 1/4 x 3/4	21/32	1 1/4	1 9/32	1 31/32	1 1/4	23/32	0.232
1 1/4 x 1 1/4 x 1	13/16	1 1/4	1 5/8	2 1/8	1 1/8	1	0.280
1 1/2 x 1 1/2 x 1/2	7/16	1 5/16	1 1/16	1 27/32	1 3/32	3/4	0.230
1 1/2 x 1 1/2 x 3/4	21/32	1 5/16	1 5/16	1 13/16	1 3/32	3/4	0.256
1 1/2 x 1 1/2 x 1	13/16	1 5/16	1 5/8	2 1/4	1 1/4	1	0.326
2 x 2 x 1	13/16	1 3/8	1 19/32	2 3/16	1 5/16	7/8	0.420
2 x 2 x 1 1/4	1	1 3/8	1 31/32	2 5/8	1 5/8	1	0.450

**90 DEGREE ELBOW
(S X S)**

PVC PART NO. 2300

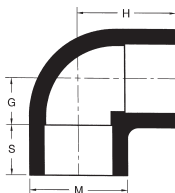

Size	Universal Part Number	M	H	G	S	Approx. Wt. (Lbs)
1/2	406-005	1 3/32	1 1/4	1/2	3/4	0.048
3/4	406-007	1 9/32	1 9/32	9/16	23/32	0.055
1	406-010	1 19/32	1 9/16	11/16	7/8	0.100
1 1/4	406-012	2	2 1/8	7/8	1 1/4	0.200
1 1/2	406-015	2 1/4	2 5/16	1	1 5/16	0.256
2	406-020	2 11/16	2 13/32	1 1/4	1 5/32	0.316
2 1/2	406-025	3 11/32	3 1/4	1 1/2	1 3/4	0.770
3	406-030	3 31/32	3 13/16	1 13/16	2	1.040
4	406-040	5	4 3/8	2 5/16	2 1/16	1.722
6	406-060	7 1/4	7	3 1/2	3 1/2	5.112
8	406-080	9 3/8	8 17/32	4 1/2	4	9.139

**REDUCING 90 DEGREE ELBOW
(S X S)**

PVC PART NO. 2300

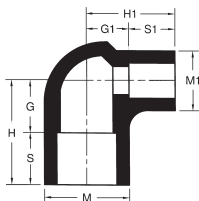

Size	Universal Part Number	M	H	G	S
3/4 X 1/2	406-101	1 5/16	1 17/32	17/32	1
1 X 1/2	406-130	1 5/8	1 11/16	9/16	1 1/8
1 X 3/4	406-131	1 5/8	1 29/32	21/32	1 1/8

Size	M1	H1	G1	S	Approx. Wt. (Lbs)
3/4 X 1/2	1 3/32	1 9/32	17/32	3/4	0.070
1 X 1/2	1 3/32	1 9/16	13/16	3/4	0.116
1 X 3/4	1 5/16	1 29/32	25/32	1	0.128

90 DEGREE ELBOW
(SX FPT)

PVC PART NO. 2301

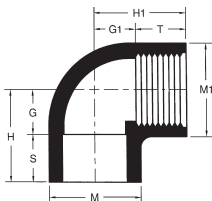

Size	Universal Part Number	M	H	G	S
1/2	407-005	1 3/32	1 1/4	1/2	3/4
3/4	407-007	1 11/32	1 9/16	9/16	1
1	407-010	1 5/8	1 7/8	3/4	1 1/8
1 1/4	407-012	2	2 3/16	15/16	1 1/4
1 1/2	407-015	2 1/4	2 5/16	1	1 5/16
2	407-020	2 3/4	2 11/16	1 5/16	1 3/8

Size	M1	H1	G1	T	Approx. Wt. (Lbs)
1/2	1 3/32	1 1/4	17/32	23/32	0.064
3/4	1 11/32	1 9/16	13/16	3/4	0.100
1	1 5/8	1 7/8	7/8	1	0.166
1 1/4	2	2 1/4	1 1/4	1	0.293
1 1/2	2 1/4	2 5/16	1 1/4	1 1/16	0.355
2	2 3/4	2 17/32	1 11/32	1 3/16	0.534

REDUCING 90 DEGREE ELBOW

(SX FPT)

PVC PART NO. 2301

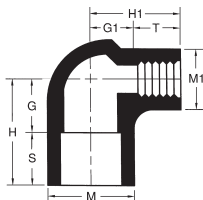

Size	Universal Part Number	L	M	H	G
$\frac{3}{4} \times \frac{1}{2}$	407-101	$1\frac{3}{8}$	$1\frac{1}{2}$	$\frac{1}{2}$	1
$1 \times \frac{1}{2}$	407-130	$1\frac{5}{8}$	$1\frac{21}{32}$	$\frac{17}{32}$	$1\frac{1}{8}$
$1 \times \frac{3}{4}$	407-131	$1\frac{5}{8}$	$1\frac{25}{32}$	$\frac{21}{32}$	$1\frac{1}{8}$

Size	S	M1	H1	G1	Approx. Wt. (Lbs)
$\frac{3}{4} \times \frac{1}{2}$	$1\frac{3}{32}$	$1\frac{3}{8}$	$\frac{19}{32}$	$\frac{25}{32}$	0.102
$1 \times \frac{1}{2}$	$1\frac{1}{16}$	$1\frac{17}{32}$	$\frac{25}{32}$	$\frac{3}{4}$	0.126
$1 \times \frac{3}{4}$	$1\frac{11}{32}$	$1\frac{19}{32}$	$\frac{27}{32}$	$\frac{3}{4}$	0.140

90 DEGREE ELBOW

(FPT X FPT)

PVC PART NO. 2302

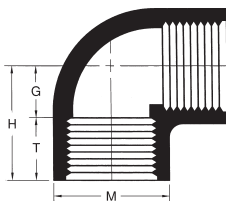

Size	Universal Part Number	M	H	G	T	Approx. Wt. (Lbs)
$\frac{1}{2}$	408-005	$1\frac{1}{16}$	$1\frac{5}{16}$	$\frac{17}{32}$	$\frac{25}{32}$	0.070
$\frac{3}{4}$	408-007	$1\frac{5}{16}$	$1\frac{15}{32}$	$\frac{21}{32}$	$\frac{13}{16}$	0.098
1	408-101	$1\frac{5}{8}$	$1\frac{13}{16}$	$\frac{13}{16}$	1	0.164

90 DEGREE STREET ELBOW

(SPG X S)

PVC PART NO. 2304

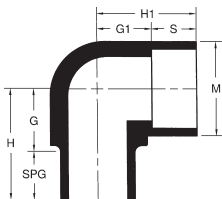

Size	Universal Part Number	H	G	SPG
1/2	409-005	1 5/32	13/32	3/4
3/4	409-007	1 3/8	9/16	25/32
1	409-010	1 13/16	11/16	1 1/8
1 1/4	409-012	1 5/32	29/32	1 1/4
1 1/2	409-015	2 7/16	1 1/8	1 5/16
2	409-020	2 3/4	1 3/8	1 3/8

Size	M	H1	G1	S	Approx. Wt. (Lbs)
1/2	1 3/32	1 1/2	3/4	3/4	0.050
3/4	1 11/32	1 19/32	13/16	13/16	0.077
1	1 19/32	2 1/8	1	1 1/8	0.132
1 1/4	2	2 15/32	1 7/32	1 1/4	0.225
1 1/2	2 1/4	2 19/32	1 9/32	1 5/16	0.292
2	2 3/4	2 27/32	1 15/32	1 3/8	0.426

**90 DEGREE STREET ELBOW
(MPTXS)**

PVC PART NO. 2306

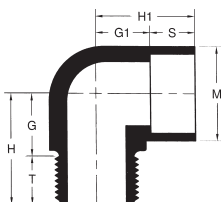

Size	Universal Part Number	H	G	T
1/2	410-005	1 5/32	13/32	3/4
3/4	410-007	1 3/8	9/16	3/4
1	410-010	1 13/16	11/16	1 1/8
1 1/4	410-012	2 3/16	15/16	1
1 1/2	410-015	2 5/16	1	1
2	410-020	2 3/4	1 3/8	1

Size	M	H1	G1	S	Approx. Wt. (Lbs)
1/2	1 3/32	1 1/2	3/4	3/4	0.048
3/4	1 11/32	1 1/32	9/32	13/16	0.076
1	1 19/32	2 1/8	1	1 1/8	0.135
1 1/4	2	2 1/4	1 1/4	1 1/4	0.212
1 1/2	2 1/4	2 13/32	1 13/32	1 5/16	0.276
2	2 3/4	2 9/16	1 9/16	1 3/8	0.436

**90 DEGREE STREET ELBOW
(MPTXFPT)**

PVC PART NO. 2307

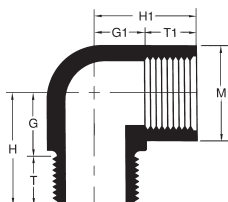

Size	Universal Part Number	H	G	T
1/2	412-005	1 15/32	23/32	3/4
3/4	412-007	1 19/32	27/32	3/4

Size	M	H1	G1	T1	Approx. Wt. (Lbs)
1/2	1 3/32	1 3/8	3/8	3/4	0.052
3/4	1 3/8	1 5/16	9/16	3/4	0.080

SIDE OUTLET ELBOW
 (S X S X FPT)

PVC PART NO. 2520

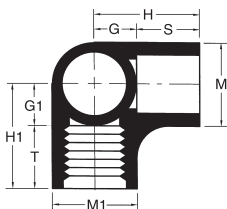

Size	Universal Part Number	M	H	G	S
$\frac{3}{4} \times \frac{3}{4} \times \frac{1}{2}$	414-101	$1 \frac{11}{32}$	$1 \frac{9}{16}$	$\frac{9}{16}$	1

Size	M1	H1	G1	T	Approx. Wt. (Lbs)
$\frac{3}{4} \times \frac{3}{4} \times \frac{1}{2}$	$1 \frac{1}{16}$	$1 \frac{1}{2}$	$\frac{3}{4}$	$\frac{3}{4}$	0.112

45 DEGREE ELBOW
 (S X S)

PVC PART NO. 2309

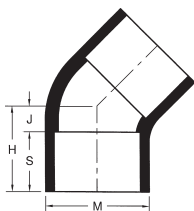

Size	Universal Part Number	M	H	J	S	Approx. Wt. (Lbs)
$\frac{1}{2}$	417-005	$1 \frac{3}{32}$	$1 \frac{1}{16}$	$\frac{5}{16}$	$\frac{3}{4}$	0.040
$\frac{3}{4}$	417-007	$1 \frac{5}{16}$	$1 \frac{1}{32}$	$\frac{5}{16}$	$\frac{23}{32}$	0.047
1	417-010	$1 \frac{21}{32}$	$1 \frac{7}{16}$	$\frac{5}{16}$	$1 \frac{1}{8}$	0.120
$1 \frac{1}{4}$	417-012	2	$\frac{3}{4}$	$\frac{1}{2}$	$1 \frac{1}{4}$	0.176
$1 \frac{1}{2}$	417-015	$2 \frac{1}{4}$	$1 \frac{29}{32}$	$\frac{19}{32}$	$1 \frac{5}{16}$	0.216
2	417-020	$2 \frac{3}{4}$	$2 \frac{1}{8}$	$\frac{3}{4}$	$1 \frac{3}{8}$	0.342
$2 \frac{1}{2}$	417-025	$3 \frac{5}{16}$	$2 \frac{15}{32}$	$\frac{11}{16}$	$1 \frac{25}{32}$	0.556
3	417-030	$3 \frac{31}{32}$	$2 \frac{27}{32}$	$\frac{27}{32}$	2	0.816
4	417-040	5	$3 \frac{5}{32}$	$1 \frac{3}{32}$	$2 \frac{1}{16}$	1.296
6	417-060	$7 \frac{1}{4}$	$5 \frac{1}{4}$	$1 \frac{3}{4}$	$3 \frac{1}{2}$	3.878
8	417-080	$9 \frac{3}{8}$	$6 \frac{27}{32}$	$2 \frac{11}{32}$	$4 \frac{1}{2}$	7.912

CROSS

(SXSXSXS)

PVC PART NO. 2410

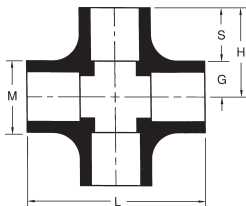

Size	Universal Part Number	L	M	H	G	S	Approx. Wt. (Lbs)
1/2	420-005	2 9/16	1 3/32	1 9/32	17/32	3/4	0.080
3/4	420-007	3 5/16	1 11/32	1 21/32	21/32	1	0.138
1	420-010	3 7/8	1 5/8	1 15/16	13/16	1 1/8	0.222
1 1/4	420-012	4 3/8	2	2 1/4	1	1 1/4	0.372
1 1/2	420-015	4 7/8	2 3/4	2 7/16	1 1/8	1 5/16	0.450
2	420-020	5 1/2	2 3/4	2 3/4	1 3/8	1 3/8	0.678

COUPLING

(SXS)

PVC PART NO. 2100

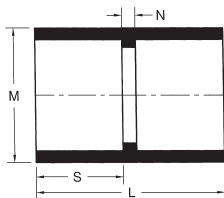

Size	Universal Part Number	L	M	N	S	Approx. Wt. (Lbs)
1/2	429-005	1 15/32	1 1/8	3/32	11/16	0.028
3/4	429-007	1 17/32	1 11/32	3/32	23/32	0.038
1	429-010	1 27/32	1 11/16	3/32	7/8	0.067
1 1/4	429-012	2 5/8	2	1/8	1 1/4	0.136
1 1/2	429-015	1 3/32	1 9/32	3/32	1 3/32	0.116
2	429-020	2 13/32	2 3/4	3/32	1 5/32	0.165
2 1/2	429-025	3 3/4	3 11/32	1/8	1 13/16	0.444
3	429-030	4	4	3/16	1 29/32	0.786
4	429-040	4 3/4	5 5/16	3/16	2 9/32	0.966
6	429-060	6 9/32	7 1/4	9/32	3	2.218
8	429-080	8 1/4	9 3/8	1/4	4	4.238

REDUCING COUPLING
(S X S)

PVC PART NO. 2100

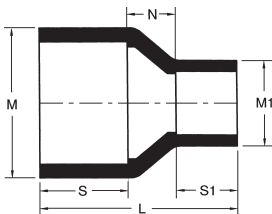

Size	Universal Part Number	L	M	M1	N	S	S1	Approx. Wt. (Lbs)
$\frac{3}{4} \times \frac{1}{2}$	429-101	$1\frac{7}{8}$	$1\frac{11}{32}$	$1\frac{1}{8}$	$\frac{1}{8}$	$\frac{3}{4}$	1	0.052
$1 \times \frac{3}{4}$	429-131	$2\frac{1}{4}$	$1\frac{11}{16}$	$1\frac{13}{32}$	$\frac{1}{8}$	$1\frac{1}{8}$	1	0.080

COUPLING
(FPT X FPT)

PVC PART NO. 2102

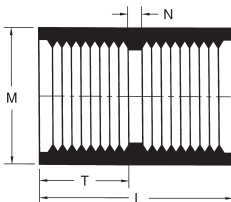

Size	Universal Part Number	L	M	N	T	Approx. Wt. (Lbs)
$\frac{1}{2}$	430-005	$1\frac{1}{2}$	$1\frac{1}{16}$	$\frac{1}{8}$	$\frac{11}{16}$	0.038
$\frac{3}{4}$	430-007	$1\frac{1}{2}$	$1\frac{9}{32}$	$\frac{1}{8}$	$\frac{11}{16}$	0.050
1	430-010	$2\frac{1}{16}$	$1\frac{5}{8}$	$\frac{3}{16}$	$\frac{15}{16}$	0.098

RISER EXTENSION
(FPT X MPT)

PVC PART NO. 2103

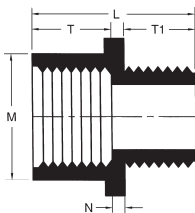

Size	Universal Part Number	L	M	T	N	T1	Approx. Wt. (Lbs)
$\frac{1}{2} \times \frac{1}{2}$	434-005	$2\frac{1}{16}$	$1\frac{1}{16}$	$\frac{9}{16}$	$\frac{3}{4}$	$\frac{3}{4}$	0.042

FEMALE ADAPTER

(S X FPT)

PVC PART NO. 2101

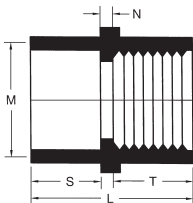

Size	Universal Part Number	L	M	N	S	T	Approx. Wt. (Lbs)
1/2	435-005	1 27/32	1 1/8	3/32	7/8	7/8	0.053
3/4	435-007	2 3/32	1 11/32	3/32	1	1	0.067
1	435-010	2 5/16	1 21/32	1/16	1 1/8	1 1/8	0.065
1 1/4	435-012	2 5/8	2	1/8	1 1/4	1 1/4	0.164
1 1/2	435-015	2 7/16	2 7/32	5/32	1 9/32	1	0.148
2	435-020	2 3/8	2 23/32	1/4	1 1/8	1	0.190
2 1/2	435-025	3 17/32	3 5/16	7/32	1 9/16	1 3/4	0.440
3	435-030	3 13/16	4	3/16	2	1 5/8	0.604
4	435-040	3 15/16	5	3/16	2 1/16	1 11/16	0.884

REDUCING FEMALE ADAPTER

(S X FPT)

PVC PART NO. 2101

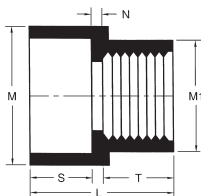

Size	Universal Part Number	L	M	M1	N	S	T	Approx. Wt. (Lbs)
3/4 X 1/2	435-101	1 33/32	1 5/16	1 1/8	3/32	1	7/8	0.058
1 X 3/4	435-131	2 1/16	1 5/8	1 5/16	1/8	1 1/8	1 3/16	0.076

MALE ADAPTER
 (MPTXS)

PVC PART NO. 2109

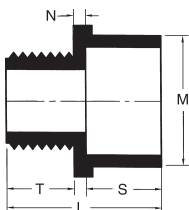

Size	Universal Part Number	L	M	N	S	T	Approx. Wt. (Lbs)
1/2	436-005	1 5/8	1 3/32	1/4	3/4	5/8	0.030
3/4	436-007	1 19/32	1 11/32	3/16	23/32	11/16	0.037
1	436-010	2 3/16	1 21/32	1/4	1 1/8	13/16	0.080
1 1/4	436-012	2 7/16	2	3/16	1 1/4	1	0.122
1 1/2	436-015	2 7/16	2 1/4	7/32	1 9/32	15/16	0.144
2	436-020	2 5/8	2 3/4	1/4	1 3/8	1	0.234
2 1/2	436-025	3 1/16	3 5/16	3/16	1 3/4	1 5/8	0.388
3	436-030	3 7/8	3 11/32	1/4	2	1 5/8	0.546
4	436-040	4	5	1/4	2 1/16	1 11/16	0.820
6	436-060	5 3/4	7 1/4	11/16	3 1/2	1 9/16	2.114

REDUCING MALE ADAPTER
 (MPTXS)

PVC PART NO. 2110

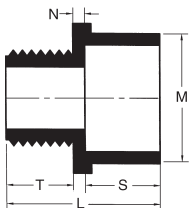

Size	Universal Part Number	L	M	N	S	T	Approx. Wt. (Lbs)
1/2 x 3/4	436-074	1 13/16	1 11/32	1/32	1	25/32	0.036
3/4 x 1/2	436-101	1 5/8	1 3/32	3/8	3/4	3/4	0.030
3/4 x 1	436-102	2 1/16	1 11/16	3/16	1 1/8	3/4	0.065
1 x 3/4	436-131	2 1/8	1 11/32	0	1	1 1/8	0.060
1 x 1 1/4	436-132	2 5/16	2	3/16	1 1/4	7/8	0.112
1 1/4 x 1	436-168	2 3/8	1 21/32	3/16	1 3/16	1	0.107
1 1/4 x 1 1/2	436-169	2 1/2	2 1/4	3/16	1 5/16	1	0.152
1 1/2 x 1 1/4	436-212	2 13/32	2	7/32	1 1/4	15/16	0.132
1 1/2 x 2	436-213	2 9/16	2 3/4	1/4	1 3/8	15/16	0.207
2 x 1 1/2	436-251	2 17/32	2 1/4	3/16	1 5/16	1 1/32	0.192

REDUCER BUSHING

(FLUSH STYLE)

(SPG X S)

PVC PART NO. 2107

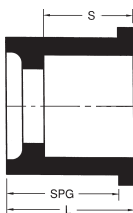

Size	Universal Part Number	L	SPG	S	Approx. Wt. (Lbs)
$\frac{3}{4} \times \frac{1}{2}$	437-101	$1\frac{1}{4}$	1	$\frac{29}{32}$	0.024
$1 \times \frac{1}{2}$	437-130	$1\frac{3}{8}$	$1\frac{1}{8}$	$\frac{29}{32}$	0.052
$1 \times \frac{3}{4}$	437-131	$1\frac{3}{8}$	$1\frac{1}{8}$	1	0.038
$1\frac{1}{4} \times \frac{1}{2}$	437-166	$1\frac{1}{2}$	$1\frac{1}{4}$	$\frac{3}{4}$	0.090
$1\frac{1}{4} \times \frac{3}{4}$	437-167	$1\frac{1}{2}$	$1\frac{1}{4}$	1	0.112
$1\frac{1}{4} \times 1$	437-168	$1\frac{9}{16}$	$1\frac{1}{4}$	$1\frac{1}{4}$	0.069
$1\frac{1}{2} \times \frac{1}{2}$	437-209	$1\frac{9}{16}$	$1\frac{1}{4}$	$\frac{3}{4}$	0.112
$1\frac{1}{2} \times \frac{3}{4}$	437-210	$1\frac{9}{16}$	$1\frac{1}{4}$	1	0.118
$1\frac{1}{2} \times 1$	437-211	$1\frac{3}{4}$	$1\frac{7}{16}$	$1\frac{1}{8}$	0.114
$1\frac{1}{2} \times 1\frac{1}{4}$	437-212	$1\frac{11}{16}$	$1\frac{3}{8}$	$1\frac{1}{4}$	0.062
$2 \times \frac{1}{2}$	437-247	$1\frac{3}{4}$	$1\frac{3}{8}$	$\frac{3}{4}$	0.170
$2 \times \frac{3}{4}$	437-248	$1\frac{3}{4}$	$1\frac{3}{8}$	1	0.164
2×1	437-249	$1\frac{3}{4}$	$1\frac{3}{8}$	$1\frac{1}{8}$	0.170
$2 \times 1\frac{1}{4}$	437-250	$1\frac{3}{4}$	$1\frac{3}{8}$	$1\frac{1}{4}$	0.205
$2 \times 1\frac{1}{2}$	437-251	$1\frac{3}{4}$	$1\frac{3}{8}$	$1\frac{3}{8}$	0.150
$2\frac{1}{2} \times \frac{1}{2}$	437-291	$2\frac{1}{8}$	$1\frac{3}{4}$	$1\frac{5}{16}$	0.334
$2\frac{1}{2} \times 2$	437-292	$2\frac{1}{8}$	$1\frac{3}{4}$	$1\frac{3}{8}$	0.260
3×2	437-338	$2\frac{3}{8}$	$1\frac{7}{8}$	$1\frac{3}{8}$	0.484
$3 \times 2\frac{1}{2}$	437-339	$2\frac{1}{4}$	$1\frac{7}{8}$	$1\frac{3}{4}$	0.420
4×2	437-420	$2\frac{5}{16}$	$2\frac{1}{16}$	$1\frac{3}{8}$	0.888
4×3	437-422	$2\frac{5}{16}$	$2\frac{1}{16}$	2	0.736
6×4	437-532	$3\frac{5}{8}$	3	2	2.001
8×4	437-582	$4\frac{11}{16}$	$4\frac{1}{16}$	$2\frac{1}{16}$	3.712
8×6	437-585	$4\frac{11}{16}$	$4\frac{1}{16}$	$3\frac{11}{16}$	3.852

REDUCER BUSHING

(FLUSH STYLE)

(SPG X FPT)

PVC PART NO. 2108

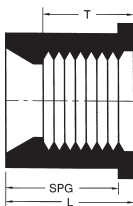

Size	Universal Part Number	L	SPG	T	Approx. Wt. (Lbs)
3/4 x 1/2	438-101	1 1/4	1	3/4	0.029
1 x 1/2	438-130	1 3/8	1 1/8	3/4	0.053
1 x 3/4	438-131	1 3/8	1 1/8	3/4	0.042
1 1/4 x 1/2	438-166	1 9/16	1 1/4	3/4	0.117
1 1/4 x 3/4	438-167	1 9/16	1 1/4	25/32	0.112
1 1/4 x 1	438-168	1 9/16	1 1/4	1	0.088
1 1/2 x 1/2	438-209	1 11/16	1 5/16	3/4	0.107
1 1/2 x 3/4	438-210	1 11/16	1 5/16	25/32	0.148
1 1/2 x 1	438-211	1 11/16	1 5/16	1	0.150
1 1/2 x 1 1/4	438-212	1 11/16	1 5/16	1	0.098
2 x 1/2	438-247	1 3/4	1 3/8	3/4	0.214
2 x 3/4	438-248	1 3/4	1 3/8	25/32	0.221
2 x 1	438-249	1 3/4	1 3/8	1	0.223
2 x 1 1/4	438-250	1 3/4	1 3/8	1	0.231
2 x 1 1/2	438-251	1 3/4	1 3/8	1 1/32	0.182
3 x 2	438-338	2 9/32	1 7/8	1 1/16	0.638
3 x 2 1/2	438-339	2 9/32	1 7/8	1 7/16	0.490
4 x 2	438-420	2 3/4	2 5/16	1	1.164
4 x 3	438-422	2 3/4	2 5/16	1 5/8	0.910
6 x 4	438-532	4	3 1/2	1 3/4	1.976

REDUCER BUSHING

(MPT X FPT)

PVC PART NO. 2112

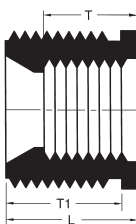

Size	Universal Part Number	L	T	T1	Approx. Wt. (Lbs)
$\frac{3}{4} \times \frac{1}{2}$	439-101	1	$\frac{3}{4}$	$\frac{3}{4}$	0.022
$1 \times \frac{3}{4}$	439-131	$1\frac{1}{4}$	$\frac{3}{4}$	1	0.044
$1\frac{1}{4} \times \frac{3}{4}$	439-167	$1\frac{5}{16}$	$\frac{3}{4}$	$\frac{3}{16}$	0.090
$1\frac{1}{4} \times 1$	439-168	$1\frac{5}{16}$	1	1	0.066
$1\frac{1}{2} \times \frac{3}{4}$	439-210	$1\frac{3}{8}$	$\frac{3}{4}$	1	0.128
$1\frac{1}{2} \times 1$	439-211	$1\frac{3}{8}$	1	$1\frac{1}{32}$	0.110
$1\frac{1}{2} \times 1\frac{1}{4}$	439-212	$1\frac{3}{8}$	1	$1\frac{1}{16}$	0.068
$2 \times 1\frac{1}{2}$	439-251	$1\frac{7}{16}$	1	$1\frac{1}{8}$	0.142

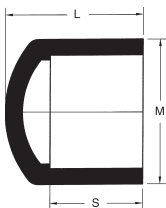
**CAP
 (S)**
PVC PART NO. 2116

Size	Universal Part Number	L	M	S	Approx. Wt. (Lbs)
1/2	447-005	1 3/32	1 3/32	3/4	0.024
3/4	447-007	1 5/16	1 5/16	1	0.035
1	447-010	1 5/8	1 19/32	1 5/32	0.060
1 1/4	447-012	1 13/16	2	1 1/4	0.094
1 1/2	447-015	1 15/16	2 1/4	1 5/16	0.116
2	447-020	2 5/32	2 3/4	1 3/8	0.184
2 1/2	447-025	2 15/32	3 5/16	1 13/16	0.358
3	447-030	2 15/16	3 31/32	1 29/32	0.467
4	447-040	3 1/8	5	2 1/32	0.720
6	447-060	4 3/4	7 1/4	3 5/8	2.254
8	447-080	6 13/32	9 3/8	4	4.074

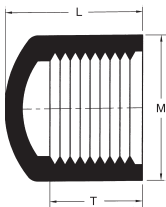
**CAP
 (FPT)**
PVC PART NO. 2117

Size	Universal Part Number	L	M	T	Approx. Wt. (Lbs)
1/2	448-005	1 1/8	1 1/8	7/8	0.033
3/4	448-007	1 1/4	1 11/32	1	0.046
1	448-010	1 9/32	1 5/8	15/16	0.068
1 1/4	448-012	1 7/16	2	1	0.108
1 1/2	448-015	1 9/16	2 1/4	1	0.140
2	448-020	2 5/8	2 3/4	1 1/16	0.192

PLUG
 (SPG)

PVC PART NO. 2118

Size	Universal Part Number	L	SPG	Approx. Wt. (Lbs)
1/2	449-005	1 ⁵ / ₁₆	3/4	0.018
3/4	449-007	1 1/4	1	0.028
1	449-010	1 3/8	1 1/8	0.054
1 1/4	449-012	1 1/2	1 1/4	0.082
1 1/2	449-015	1 5/8	1 5/16	0.102
2	449-020	1 3/4	1 3/8	0.152

PLUG
 (MPT)

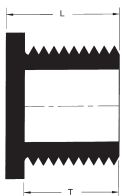
PVC PART NO. 2113

Size	Universal Part Number	L	T	Approx. Wt. (Lbs)
1/2	450-005	1 ⁵ / ₁₆	3/4	0.017
3/4	450-007	1	3/4	0.028
1	450-010	1 1/4	1	0.050
1 1/4	450-012	1 5/16	1 1/32	0.074
1 1/2	450-015	1 5/16	1 1/32	0.106
2	450-020	1 15/32	1 1/16	0.184

FlowGuard Gold® Pipe

Possession of this price list shall not be construed as an offer to sell the products listed.



CPVC Copper Tube Size Pipe

STRAIGHT LENGTHS PLAIN END SDR 11 CPVC COPPER TUBE SIZE PIPE ASTM D 2846											
PART NO.	NOM. SIZE	UPC # 611942-	QTY. PER BUNDLE	TRUCKLOAD PERCENT PER SKID	QTY. PER SKID	AVG. OD (IN.)	NOM. ID (IN.)	MIN. WALL (IN.)	MAX WORK PRESSURE AT 23°C OR 73°F	WT. PER 100 FT. (LBS.)	LIST PRICE PER 100 FT.
CTS 12005	1/2" x 10'	04979	500'	2.083	12,000'	.625	.485	.068	400 PSI	8.3	\$87.47
CTS 12005	1/2" x 20'	04993	1,000'	5.000	24,000'	.625	.485	.068	400 PSI	8.3	\$87.47
CTS 12007	3/4" x 10'	04980	250'	2.083	6,000'	.875	.713	.080	400 PSI	13.9	\$157.83
CTS 12007	3/4" x 20'	05145	500'	5.000	12,000'	.875	.713	.080	400 PSI	13.9	\$157.83
CTS 12010	1" x 10'	05146	150'	2.083	3,600'	1.125	.921	.102	400 PSI	22.2	\$322.28
CTS 12010	1" x 20'	05147	300'	5.000	7,200'	1.125	.921	.102	400 PSI	22.2	\$322.28
CTS 12012	1 1/4" x 10'	05148	100'	2.083	2,400'	1.375	1.125	.125	400 PSI	33.3	\$478.33
CTS 12012	1 1/4" x 20'	05321	200'	5.000	4,800'	1.375	1.125	.125	400 PSI	33.3	\$478.33
CTS 12015	1 1/2" x 10'	05150	60'	2.083	1,440'	1.625	1.329	.148	400 PSI	46.6	\$634.40
CTS 12015	1 1/2" x 20'	05306	120'	5.000	2,880'	1.625	1.329	.148	400 PSI	46.6	\$634.40
CTS 12020	2" x 10'	05152	40'	2.083	960'	2.125	1.739	.193	400 PSI	79.5	\$1,073.99
CTS 12020	2" x 20'	05322	80'	5.000	1,920'	2.125	1.739	.193	400 PSI	79.5	\$1,073.99

NOTE: STRAIGHT LENGTH PIPE ARE SHIPPED IN FULL BUNDLE QUANTITY ONLY.

COILED PIPE SDR 11 COILED SDR CPVC COPPER TUBE SIZE PIPE ASTM D 2846											
PART NO.	NOM. SIZE	UPC # 611942-	QTY. PER BUNDLE	TRUCKLOAD PERCENT PER SKID	QTY. PER SKID	AVG. OD (IN.)	NOM. ID (IN.)	MIN. WALL (IN.)	MAX WORK PRESSURE AT 23°C OR 73°F	WT. PER 100 FT. (LBS.)	LIST PRICE PER 100 FT.
CTS 12005	1/2" x 150'	05313	150'	4.166	3,750'	.625	.485	.068	400 PSI	8.5	\$103.12
CTS 12007	3/4" x 100'	05314	100'	4.166	2,500'	.875	.713	.080	400 PSI	14.0	\$185.91
CTS 12010	1" x 100'	10643	100'	4.166	1,200'	1.125	.921	.102	400 PSI	22.2	\$366.67

NSF Listed. Meets All Requirements of ASTM D 2846.

CPVC piping products are not recommended for use with compressed air or gases.



FlowGuard Gold® Fittings

MINIMUM DIMENSIONS FROM CENTER TO END OF SOCKET (LAYING LENGTH) FOR CPVC 41, SDR 11 FITTINGS

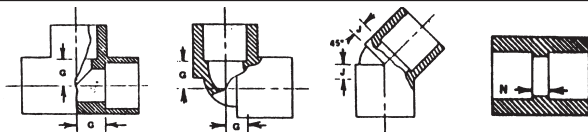

NOMINAL SIZE (IN.)	"G" MINIMUM IN. (mm)	"J" MINIMUM IN. (mm)	"N" MINIMUM IN. (mm)
1/2	0.382 (9.70)	0.183 (4.65)	0.102 (2.59)
3/4	0.507 (12.88)	0.235 (5.97)	0.102 (2.59)
1	0.633 (16.08)	0.287 (7.29)	0.102 (2.59)
1 1/4	0.758 (19.25)	0.339 (8.61)	0.102 (2.59)
1 1/2	0.884 (22.45)	0.391 (9.93)	0.102 (2.59)
2	1.134 (28.83)	0.495 (12.57)	0.102 (2.59)

TAPERED SOCKET DIMENSIONS FOR CPVC 41, SDR 11 PLASTIC PIPE FITTINGS

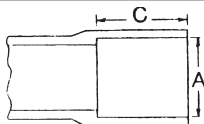

NOMINAL SIZE (IN.)	SOCKET ENTRANCE DIAMETER, IN. (mm) "A" AVERAGE	SOCKET LENGTH, IN. (mm) "C" MINIMUM
1/2	0.633 (16.08)	0.500 (12.70)
3/4	0.884 (22.45)	0.700 (17.78)
1	1.135 (28.83)	0.900 (22.86)
1 1/4	1.386 (35.20)	1.100 (27.94)
1 1/2	1.640 (41.66)	1.300 (33.02)
2	2.141 (54.38)	1.700 (43.18)

LIMITED WARRANTY

Charlotte Pipe and Foundry Company® (Charlotte Pipe®) Products are warranted to be free from manufacturing defects and to conform to currently applicable ASTM standards for a period of five years from date of delivery. Buyer's remedy for breach of this warranty is limited to replacement of, or credit for, the defective product. This warranty excludes any expense for removal or reinstallation of any defective product and any other incidental, consequential, or punitive damages. **This limited warranty is the only warranty made by seller and is expressly in lieu of all other warranties, express and implied, including any warranties of merchantability and fitness for a particular purpose.** No statement, conduct or description by Charlotte Pipe or its representative, in addition to or beyond this Limited Warranty, shall constitute a warranty. This Limited Warranty may only be modified in writing signed by an officer of Charlotte Pipe.

This Limited Warranty will not apply if:

- 1) The Products are used for purposes other than their intended purpose as defined by local plumbing and building codes, and the applicable ASTM standard.
- 2) The Products are not installed in good and workmanlike manner consistent with normal industry standards; installed in compliance with the latest instructions published by Charlotte Pipe and good plumbing practices; and installed in conformance with all local plumbing, fire and building code requirements.
- 3) The Products fail due to defects or deficiencies in design, engineering, or installation of the piping system of which they are a part.
- 4) The Products have been the subject of modification; misuse; misapplication; improper maintenance or repair; damage caused by the fault or negligence of anyone other than Charlotte Pipe; or any other act or event beyond the control of Charlotte Pipe.
- 5) The Products fail due to the freezing of water in the Products.
- 6) The Products fail due to contact with chemical agents, fire stopping materials, thread sealant, plasticized vinyl products, or other aggressive chemical agents that are not compatible.
- 7) Pipe outlets, sound attenuation systems or other devices are permanently attached to the surface of Charlotte® PVC, ABS or CPVC products with solvent cement or adhesive glue.

Any product proved to be defective in manufacture will be replaced F.O.B. point of original delivery, or credit issued, at the discretion of Charlotte Pipe. **Purchaser must obtain written permission and/or a return goods authorization** and instructions for return shipment to Charlotte Pipe of any product claimed defective, shipped in error or excess of inventory needs.

All products alleged to be defective **must** be made available to Charlotte Pipe at the following address for verification, inspection and determination of cause:

Charlotte Pipe and Foundry Company
Attention: Warranty Department
P.O. Box 35430
Charlotte, North Carolina 28235

Warning: Charlotte Pipe products are not to be used with compressed air or gases. Charlotte Pipe **does not recommend** that piping systems that include its products be tested with compressed air or gases.

05/30/08

Charlotte and Charlotte Pipe are registered trademarks of Charlotte Pipe and Foundry Company.

FlowGuard Gold® CPVC CTS Limited Warranty

Charlotte Pipe and Foundry Company (Charlotte Pipe®) warrants to the original owner of the structure in which its FlowGuard Gold CTS CPVC Pipe and Fittings (the "Products") have been installed, that the Products will be free from manufacturing defects and conform to currently applicable ASTM standards under normal use and service for a period of ten years. Buyer's remedy for breach of this warranty is limited to replacement of, or credit for, the defective product. This warranty excludes any expense for removal or reinstallation of any defective product and any other incidental, consequential, or punitive damages. **This limited warranty is the only warranty made by seller and is expressly in lieu of all other warranties, express and implied, including any warranties of merchantability and fitness for a particular purpose.** No statement, conduct or description by Charlotte Pipe or its representative, in addition to or beyond this Limited Warranty, shall constitute a warranty. This Limited Warranty may only be modified in writing signed by an officer of Charlotte Pipe.

This Limited Warranty will not apply if:

- 1) The Products are used for purposes other than the transmission of domestic water.
- 2) The Products are not installed in good and workmanlike manner consistent with normal industry standards; installed in compliance with the latest instructions published by Charlotte Pipe and good plumbing practices; and installed in conformance with all local plumbing, fire and building code requirements.
- 3) The Products fail due to defects or deficiencies in design, engineering, or installation of the water distribution system of which they are a part.
- 4) The Products have been the subject of modification; misuse; misapplication; improper maintenance or repair; damage caused by the fault or negligence of anyone other than Charlotte Pipe; or any other act or event beyond the control of Charlotte Pipe.
- 5) The Products fail due to the freezing of water in the Products.
- 6) The Products fail due to contact with chemical agents, fire stopping materials, thread sealant, plasticized vinyl products, or other aggressive chemical agents not compatible with CPVC compounds.

The Limited Warranty will not apply to any Products for which a defect is claimed unless written notice is mailed to Charlotte Pipe at the address listed below within 30 days after the date of discovery of any such defect.

All products alleged to be defective **must** be made available to Charlotte Pipe at the following address for verification, inspection and determination of cause:

Charlotte Pipe and Foundry Company
Attention: Warranty Department
P.O. Box 35430
Charlotte, North Carolina 28235

Any product proved to be defective in manufacture will be replaced F.O.B. point of original delivery, or credit will be issued, at the discretion of Charlotte Pipe. **Purchaser must obtain written permission and/or a return goods authorization** and instructions for return shipment to Charlotte Pipe of any product claimed defective, shipped in error or excess of inventory needs.

Charlotte Pipe products are manufactured to the applicable ASTM standard. Charlotte Pipe and Foundry cannot accept responsibility for the performance, dimensional accuracy, or compatibility of pipe, fittings, gaskets, or couplings not manufactured or sold by Charlotte Pipe and Foundry.

Warning: Charlotte Pipe products are **not** to be used with compressed air or gases. Charlotte Pipe **does not recommend** that piping systems that include its products or components be tested with compressed air or compressed gases.

03/24/08

Charlotte Pipe is a registered trademark of Charlotte Pipe and Foundry Company.
FlowGuard Gold is a registered trademark of The Lubrizol Corporation.

CHARLOTTE

PIPE AND FOUNDRY COMPANY

PO BOX 35430

CHARLOTTE

NORTH CAROLINA 28235

PHONE (704) 348-6450

(800) 438-6091

FAX (800) 553-1605

LITERATURE BY FAX (800) 745-9382

WWW.CHARLOTTEPIPE.COM

